

Multi-Jet dry type cold water meter improved by Teksan experience



- Multi-jet dry type
- 360°C rotatable cover.
- Display on 5 drums m<sup>3</sup> and 4 pointers for litres
- Optional check valve
- Magnetic field protection
- Measuring range up to R160
- Optional pulse, M-bus, Radio frequency output
- Hermetically sealed register (IP68)
- Brass housing
- Water temperature up to 50°C



## Technical Specifications

Nominal diameter	DN	mm	15	20	20	20	25	40
Nominal flow rate	Q <sub>3</sub>	m <sup>3</sup> /h	2,5	2,5	4	4	6,3	16
Maximum flow rate	Q <sub>4</sub>	m <sup>3</sup> /h	3,125	3,125	5	5	7,9	20
Minimum flow rate	Q <sub>1</sub>	l/h	31,2/25/15,6	31,2/25/15,6	50/40/25	50/40/25	78,7/63/39,3	200/160/100
Transitional flow rate	Q <sub>2</sub>	l/h	50/40/25	50/40/25	80/64/40	80/64/40	126/100,8/63	320/256/160
Maximum working pressure	P <sub>max</sub>	bar	16	16	16	16	16	16
Pressure loss (max.Q3)	ΔP	bar	0,4	0,4	0,63	0,63	0,63	0,63
Maximum working temperature	T <sub>max</sub>	°C	50	50	50	50	50	50
Measuring range	Q <sub>3</sub> /Q <sub>1</sub>	R	80/100/160	80/100/160	80/100/160	80/100/160	80/100/160	80/100/160
Overall length	l	mm	165	190	130	190	260	300
Maximum register indication		m <sup>3</sup>	99.999	99.999	99.999	99.999	99.999	99.999
Verification scale interval	l		0,05	0,05	0,05	0,05	0,05	0,05
Width	B	mm	95	95	95	95	98	133
Total Height	H	mm	112	112	129	112	122	175
Height to pipe axis	h	mm	34	34	37	34	41	51
Connection thread of meter	-	-	G3/4B	G1B	G1B	G1B	G1 1/4B	G2B
Nominal size	DN	mm	15	20	20	20	25	40
Piping dimensions	-	-	G1/2B	G3/4B	G3/4B	G3/4B	G1B	G1 1/2B
Weight	-	kg	1,350	1,350	1,350	1,550	2,460	5,150
Installation position	-	-	H	H	H	H	H	H

## Dimensions

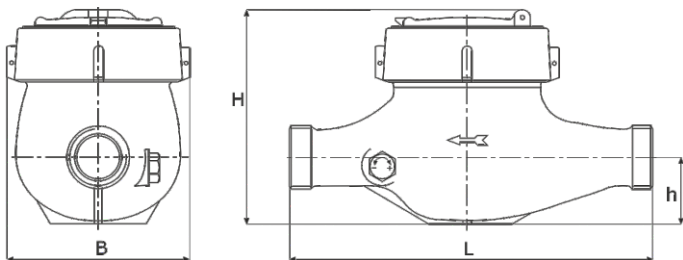

## Error Curve

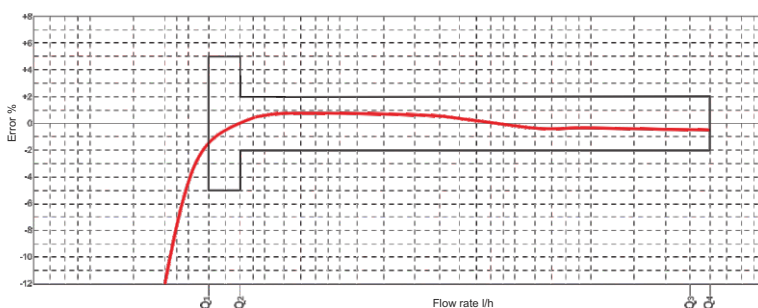

## Pressure Loss

