

BELKI Deep Bed Band Filter 4,5.60 - 12.20



4,5.60



7.10

Area of use

A deep bed band filter is an all-round and reliable filter for filtration of fluids. The BELKI Deep Bed Band Filter can be used for many processing fluids, for example grinding fluids, coolants and degreasers. Dependent on the application and requirement a deep bed band filter can be added with a magnetic filter for fine filtration of magnetic particles, smaller than the mesh size of the filter media.

Operation

The fluid is filtered through a non-woven filter media; the quality is chosen after the specific application. The used filter media is separated from the filter cake and can be removed separately. The filtration becomes more efficient if the filter cake which is built on the filter media, is not washed away. In contrast the filter cake establishes a filter layer that retains small particles.

Advantages

A BELKI Deep Bed Band Filter gives the best utilisation of the filter media. No leaks occur due to rupture or overflow. A BELKI Deep Bed Band Filter is designed in stainless steel which ensures low maintenance and a long lifetime.

Technical Specifications

4,5.60

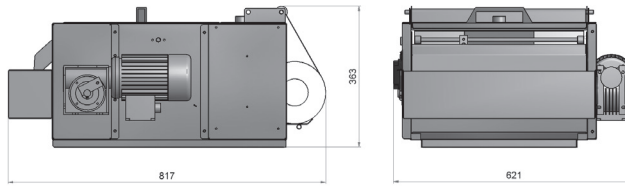

5.10

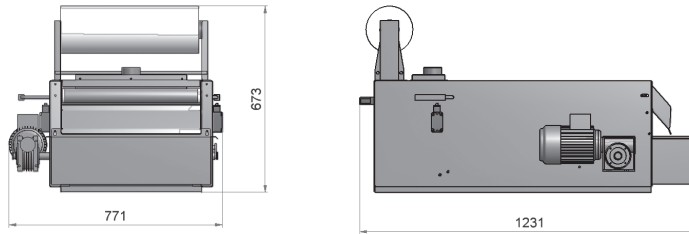

7.10

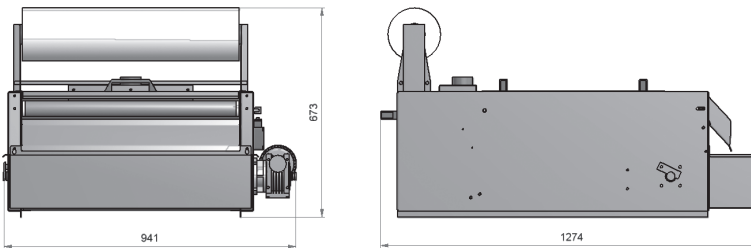

10.15

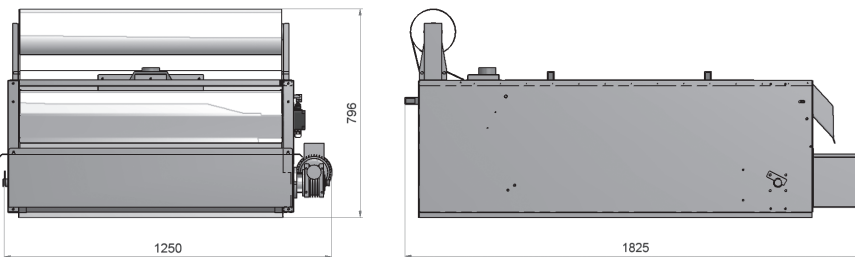

12.20

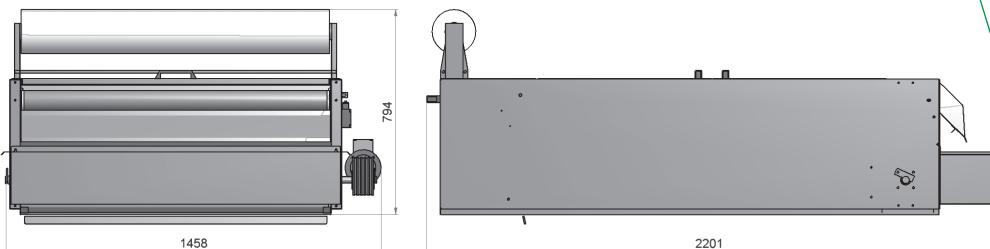

Tank Options:

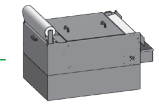

Category 1 tank

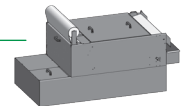

Category 2 tank

Type:		4,5.60	5.10	7.10	10.15	12.20
* Filter Capacity	Max l/min	50	150	225	350	500
Filter surface	m ²	0,2	0,35	0,50	1,0	2,0
Degree of filtration	µm	20 - 80	20 - 80	20 - 80	20 - 80	20 - 80
Acidity	pH - value	5 - 10	5 - 10	5 - 10	5 - 10	5 - 10
Temperature	°C	20 - 60	20 - 60	20 - 60	20 - 60	20 - 60
Connection	V/Hz	3x400/50	3x400/50	3x400/50	3x400/50	3x400/50
Length	mm	817	1231	1274	1825	2201
Width	mm	621	771	941	1250	1458
Height	mm	363	673	673	796	794

Presented by / Überreicht durch:

* Max l/min by coolants/lubricants for turning and milling

BELKI

Filtration with capacity