

Toggle Clamps

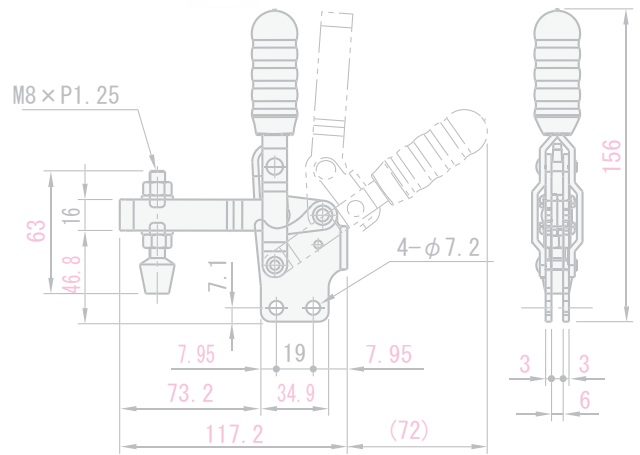

2009.5 – 2010.3

RoHS

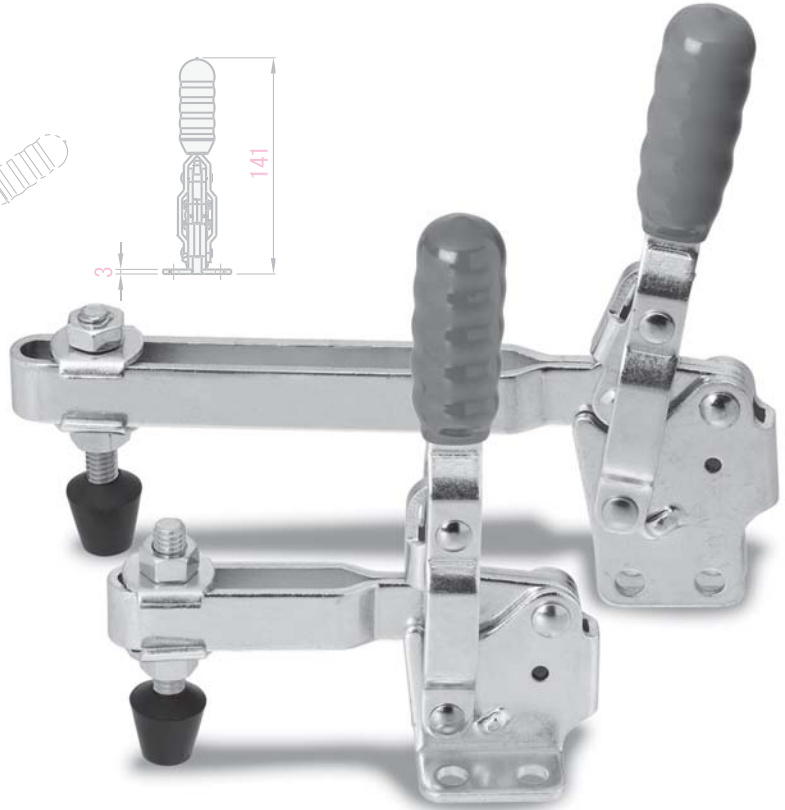
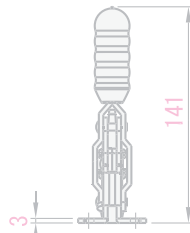
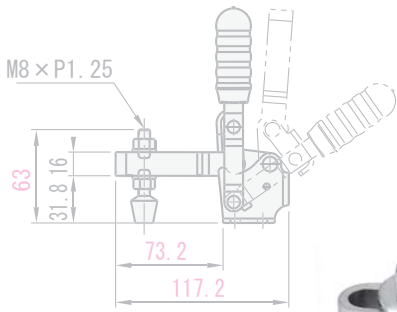
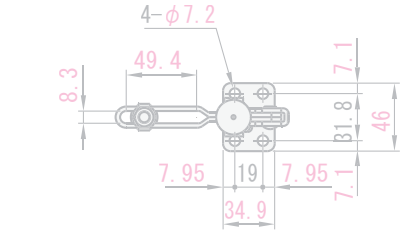

This brochure offers you at a glance an overview of all new Toggle Clamps that MISUMI has started introducing from May, 1st 2009 on the market.

The new Toggle Clamps offer the following benefits:

- ⇒ All our new Toggle Clamps **meet RoHS requirements**
- ⇒ **17% price reduction** on average compared to the replaced units
- ⇒ 5 new Toggle Clamp models

These new types are **not** included in our brand new catalogue “Mechanical components for assembly automation” (Chapter “Toggle Clamps” Page 1083-1093).

Blue Types show you old parts with the related catalogue page for your reference. **(P.2)**

Pink Types show you new Types with the related flyer page for your reference. **(P.2)**

From page 3-21 you will find on the left hand side the old part number and on the right hand side the new part number.

On page 22 the brand new 5 models are listed.

All modifications in the specifications are shown in **red**.

No changes in the delivery time between old and new toggle clamp models will occur.

All toggle clamps not listed in the table are still available at the same conditions illustrated in the MISUMI catalogue 2009.

Shape	Attachment Part	Old Part Number	Catalog Page	New Part Number	Flyer Page
01: Horizontal Handle Type	Flanged	HH150	1083	MC01-1	3
		HH250		MC01-2	
		HH350		MC01-3	
		HH450	1083	MC01-4	4
		SHH150	1083	MC01-S1	3
		SHH250		MC01-S2	
		SHH350		MC01-S3	
		SHH450		MC01-S4	
	Straight	HH150S	1083	MC01-1S	4
		HH250S	1083	MC01-2S	5
		HH350S		MC01-3S	
		HH450S	MC01-4S		
	Flanged	TC01	1085	MC01-5	7
		TC04		MC01-6	
		TC03		MC01-7	
		TC38BS	1085	MC01-8	8
		TC38BL	1085	MC01-9	7
		STC04		MC01-S6	
		STC38BS	1085	MC01-S8	8
		STC38BL		MC01-S9	
Straight	TC38BSK	1085	MC01-8S	9	
	TC38BLK	MC01-9S			
01L: Horizontal Handle Type, Long Handle	Flanged	HH150ZL	1084	MC01L-1	6
HH250ZL	MC01L-2				
HH350ZL	MC01L-3				
02: Free Attachable Type	-	FM50M	1086	MC02-1	9
SFM50M	MC02-S1				
FM150M	MC02-2				
SFM150M	MC02-S2				
03: Horizontal Type	Flanged	FM250M	1086	MC02-3	10
		TSL10		MC03-1	
STSL10		MC03-S1	10		
TSL50L		MC03-2			
TSL50R	MC03-3				
04: Vertical Handle Type	Flanged	HV150	1087	MC04-1	10
		HV250	1087	MC04-2	11
		HV450		MC04-3	
		HV650		MC04-4	
		SHV150	1087	MC04-S1	10
		SHV250	1087	MC04-S2	11
	SHV450	-	MC04-S3	22	
	-		MC04-5 *		
	Straight	HV150S	1087	MC04-1S	12
		HV250S		MC04-2S	
		HV450S		MC04-3S	
		HV650S		MC04-4S	
	Flanged	HV150L	1088	MC04-1L	13
		HV250L	1088	MC04-2L	14
		HV450L		MC04-3L	
		HV650L		MC04-4L	
		TC09	1089	MC04-6	15
		TC40A		MC04-7	
		TC42A		MC04-8	
		TC41BS		MC04-9	
STC09		1089	MC04-S6	14	
STC40A		1089	MC04-S7	15	
STC42A	-	MC04-S8	22		
-		MC04-1LS *			
-		MC04-2LS *			
-		MC04-3LS *			
Straight	-	1089	MC04-4LS *	16	
	TC09S		MC04-6S		
	TC40K		MC04-7S		
	TC42K		MC04-8S		
TC41BSS	1089	MC04-9S	17		
05:2-Pronged Type	Flanged	FT2	1090	MC05-1	17
06:Long Arm Type		LN2B	1090	MC06-1	17
07:Push-Pull Type		TC06	1091	MC07-1	18
		TC07		MC07-2	
		TC02		MC07-3	
		TC51BS	1091	MC07-4	19
		TC51BXS	MC07-5		
		TC50A	1091	MC07-6	20
08:Stroke Smooth Type		TC02SM	1092	MC08-1	20
09:Welding Clamp		-	VARI-1	1092	MC09-1
VARI-2	MC09-2				
VARI-3	MC09-3				
Metallic Heads for Clamps	-	TGB4-13	1093	MC4-15	21
		STGB4-13		MCS4-15	
		TGB4-32		MC4-32	
		STGB4-32		MCS4-32	
		TGB6-87		MC6-87	
		TGB6-37		MC6-37	
		STGB6-37		MCS6-37	
		TGB8-105		MC8-105	
		TGB8-49		MC8-45	
		STGB8-49		MCS8-45	
		TGB10-59		MC10-59	
		TGB12-66		MC12-66	

Bottom Holder/Horizontal Handle Type, Standard Handle

Part Number	HH150	SHH150	Open-Close Angle of Arm	95°
Body Material	1.0040(Ust.42.2)	1.4301(XSC/Ni18-10)	Open-Close Angle of Handle	70°
Surface Treatment	Bright Chromate Plating	-	Mounting Bolt	M4
Accessory	*Nylon Bolt	Stainless Steel Bolt	Fixing Pitch	15.9x16
Unit Price Qty. 1~9	7,20	17,60	Suppress Pressure(N)	264.6
			Tare(g)	30

HH150 SHH150

*Not bolt with rubber.

Old

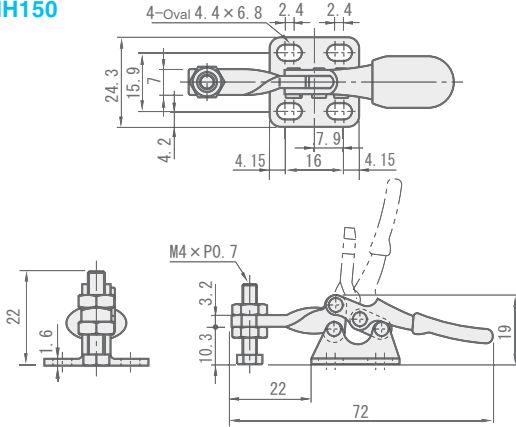

Part Number	MC01-1	MC01-S1	Open-Close Angle of Arm	90°
Body Material	1.0040(Ust.42.2)	1.4301(XSC/Ni18-10)	Open-Close Angle of Handle	75°
Surface Treatment	Tivalent Chromate	-	Mounting Bolt	M4
Accessory	*Nylon Bolt	Stainless Steel Bolt	Fixing Pitch	15.9x16
Unit Price Qty. 1~19	6,12	14,08	Suppress Pressure(N)	264.6
			Tare(g)	30

MC01-1 MC01-S1

*Not bolt with rubber.

RoHS

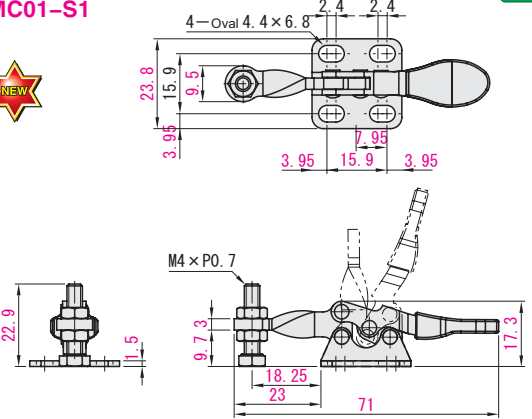

Part Number	HH250	SHH250	Open-Close Angle of Arm	95°
Body Material	1.0040(Ust.42.2)	1.4301(XSC/Ni18-10)	Open-Close Angle of Handle	70°
Surface Treatment	Bright Chromate Plating	-	Mounting Bolt	M4
Accessory	*Nylon Bolt	Stainless Steel Bolt	Fixing Pitch	15.9x16
Unit Price Qty. 1~9	7,28	17,60	Suppress Pressure(N)	264.6
			Tare(g)	30

HH250 SHH250

*Not bolt with rubber.

Old

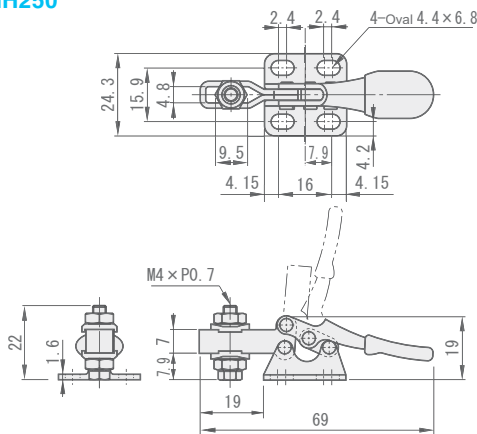

Part Number	MC01-2	MC01-S2	Open-Close Angle of Arm	90°
Body Material	1.0040(Ust.42.2)	1.4301(XSC/Ni18-10)	Open-Close Angle of Handle	75°
Surface Treatment	Tivalent Chromate	-	Mounting Bolt	M4
Accessory	*Nylon Bolt	Stainless Steel Bolt	Fixing Pitch	15.9x16
Unit Price Qty. 1~19	6,19	14,08	Suppress Pressure(N)	264.6
			Tare(g)	35

MC01-2 MC01-S2

*Not bolt with rubber.

RoHS

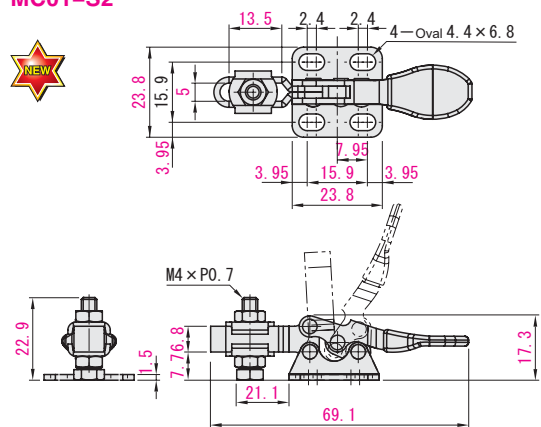

Part Number	HH350	SHH350	Open-Close Angle of Arm	90°
Body Material	1.0040(Ust.42.2)	1.4301(XSC/Ni18-10)	Open-Close Angle of Handle	60°
Surface Treatment	Bright Chromate Plating	-	Mounting Bolt	M5
Accessory	Bolt with Rubber Material NBR Hardness Shore A70	Stainless Steel Bolt	Fixing Pitch	22.2x27
Unit Price Qty. 1~9	9,60	23,84	Suppress Pressure(N)	882
			Tare(g)	120

HH350 SHH350

Old

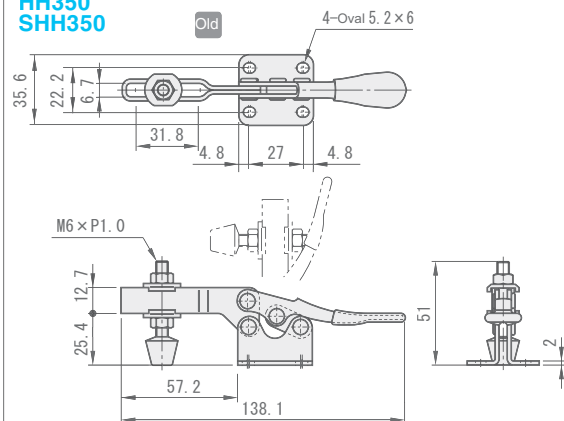

Part Number	MC01-3	MC01-S3	Open-Close Angle of Arm	85°
Body Material	1.0040(Ust.42.2)	1.4301(XSC/Ni18-10)	Open-Close Angle of Handle	73°
Surface Treatment	Tivalent Chromate	-	Mounting Bolt	M5
Accessory	Bolt with Rubber Material NBR Hardness Shore A70	Stainless Steel Bolt	Fixing Pitch	22x27
Unit Price Qty. 1~19	8,16	17,88	Suppress Pressure(N)	882
			Tare(g)	130

MC01-3 MC01-S3



RoHS

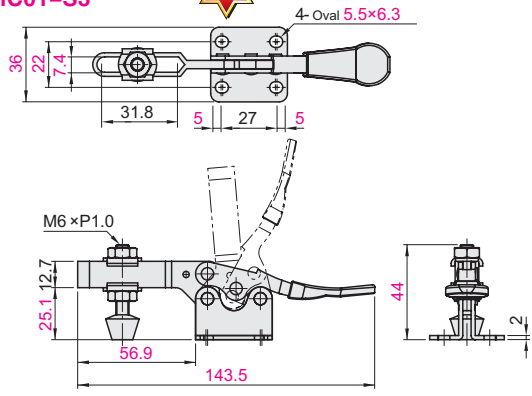

Part Number	HH450	SHH450	Open-Close Angle of Arm	90°
			Open-Close Angle of Handle	60°
Body Material	1.0040/Ust.42.2	1.4301/XSC/Ni18-10	Mounting Bolt	M6
Surface Treatment	Bright Chromate Plating	-	Fixing Pitch	22.2x25.4
Accessory	Bolt with Rubber Material NBR Hardness Shore A70	Stainless Steel Bolt	Suppress Pressure(N)	2352
Unit Price Qty. 1~9	10,24	35,50	Tare(g)	260

HH450 SHH450

RoHS

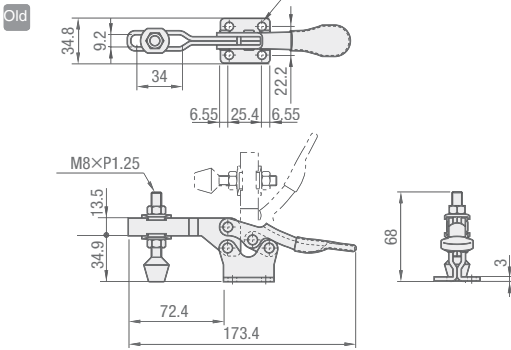

Part Number	MC01-4	MC01-S4	Open-Close Angle of Arm	90°
			Open-Close Angle of Handle	65°
Body Material	1.0040/Ust.42.2	1.4301/XSC/Ni18-10	Mounting Bolt	M6
Surface Treatment	Trivalent Chromate	-	Fixing Pitch	22.2x25.4
Accessory	Bolt with Rubber Material NBR Hardness Shore A70	Stainless Steel Bolt	Suppress Pressure(N)	2352
Unit Price Qty. 1~19	9,22	26,63	Tare(g)	265

MC01-4 MC01-S4

RoHS

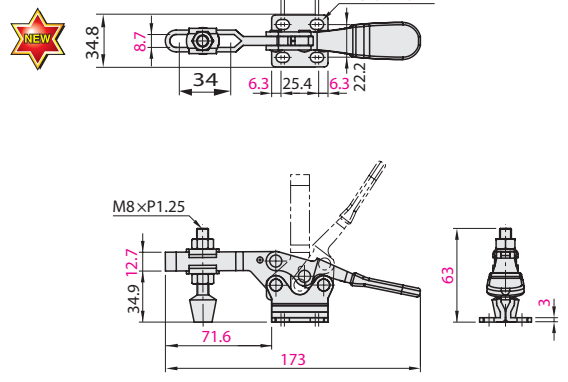

Bottom Holder/Horizontal Handle Type, Standard Handle (Straight Base)

Part Number	HH150S		Open-Close Angle of Arm	95°
			Open-Close Angle of Handle	70°
Body Material	1.0040/Ust.42.2		Mounting Bolt	M4
Surface Treatment	Trivalent Chromate		Fixing Pitch	11.2
Accessory	*Nylon Bolt		Suppress Pressure(N)	264.6
Unit Price Qty. 1~9	9,70		Tare(g)	30

HH150S

*Not bolt with rubber.

RoHS

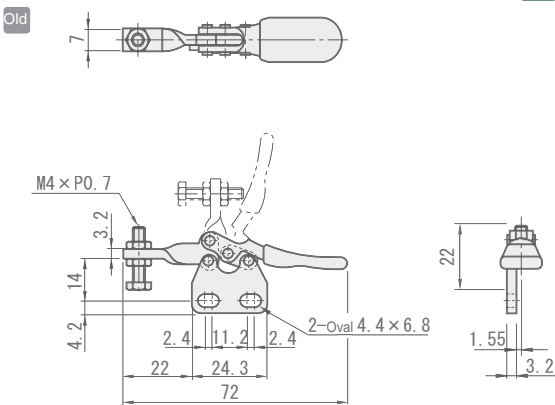

Part Number	MC01-1S		Open-Close Angle of Arm	90°
			Open-Close Angle of Handle	75°
Body Material	1.0040/Ust.42.2		Mounting Bolt	M4
Surface Treatment	Trivalent Chromate		Fixing Pitch	11.1
Accessory	*Nylon Bolt		Suppress Pressure(N)	264.6
Unit Price Qty. 1~19	8,25		Tare(g)	30

MC01-1S

*Not bolt with rubber.

RoHS

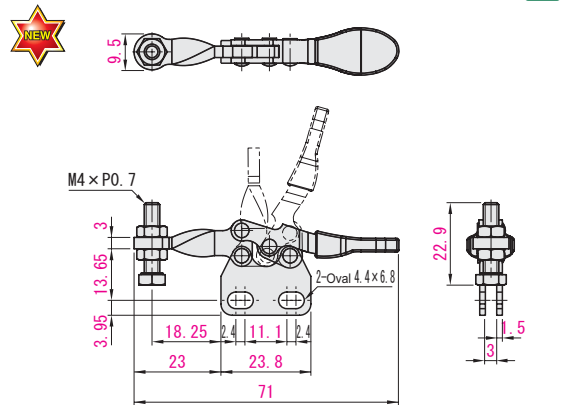

Part Number	HH250S		Open-Close Angle of Arm	95°
			Open-Close Angle of Handle	70°
Body Material	1.0040/Ust.42.2		Mounting Bolt	M4
Surface Treatment	Trivalent Chromate		Fixing Pitch	11.2
Accessory	*Nylon Bolt		Suppress Pressure(N)	264.6
Unit Price Qty. 1~9	9,80		Tare(g)	30

HH250S (Straight Base)

*Not bolt with rubber.

RoHS

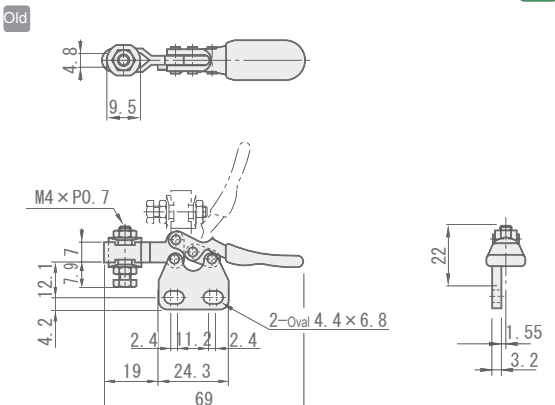

Part Number	MC01-2S		Open-Close Angle of Arm	90°
			Open-Close Angle of Handle	75°
Body Material	1.0040/Ust.42.2		Mounting Bolt	M4
Surface Treatment	Trivalent Chromate		Fixing Pitch	11.1
Accessory	*Nylon Bolt		Suppress Pressure(N)	264.6
Unit Price Qty. 1~19	8,33		Tare(g)	35

MC01-2S

*Not bolt with rubber.

RoHS

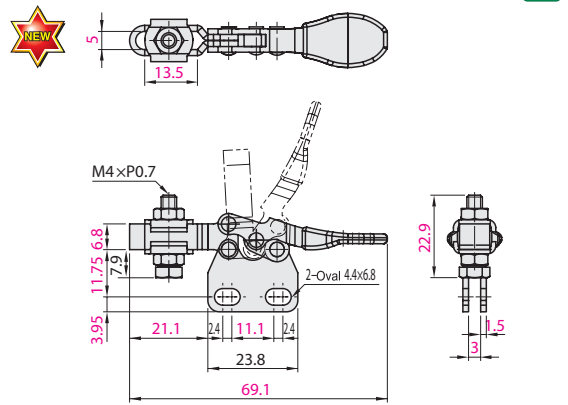

Part Number	HH350S	Open-Close Angle of Arm	90°
		Open-Close Angle of Handle	60°
Body Material	1.0040/Ust.42.2	Mounting Bolt	M5
Surface Treatment	Trivalent Chromate	Fixing Pitch	27
Accessory	Bolt with Rubber Material NBR Hardness Shore A70	Suppress Pressure(N)	882
Unit Price Qty. 1~9	12,70	Tare(g)	120

HH350S (Straight Base)

RoHS

Old

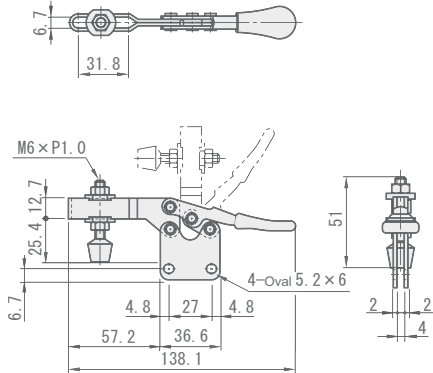

Part Number	HH450S	Open-Close Angle of Arm	90°
		Open-Close Angle of Handle	60°
Body Material	1.0040/Ust.42.2	Mounting Bolt	M6
Surface Treatment	Trivalent Chromate	Fixing Pitch	25.4
Accessory	Bolt with Rubber Material NBR Hardness Shore A70	Suppress Pressure(N)	2352
Unit Price Qty. 1~9	13,50	Tare(g)	260

HH450S (Straight Base)

RoHS

Old

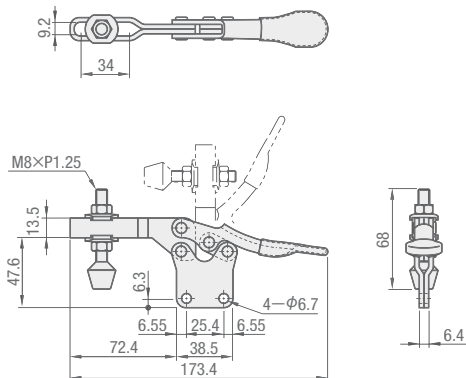

Part Number	MC01-3S	Open-Close Angle of Arm	85°
		Open-Close Angle of Handle	73°
Body Material	1.0040/Ust.42.2	Mounting Bolt	M5
Surface Treatment	Trivalent Chromate	Fixing Pitch	27
Accessory	Bolt with Rubber Material NBR Hardness Shore A70	Suppress Pressure(N)	882
Unit Price Qty. 1~19	9,53	Tare(g)	130

MC01-3S

RoHS

NEW

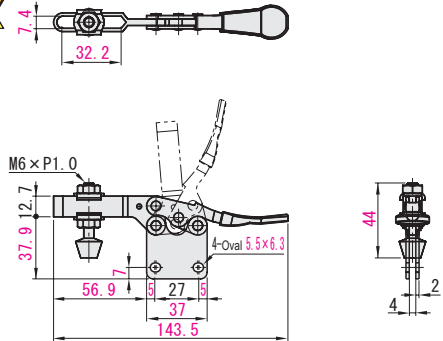

Part Number	MC01-4S	Open-Close Angle of Arm	90°
		Open-Close Angle of Handle	65°
Body Material	1.0040/Ust.42.2	Mounting Bolt	M6
Surface Treatment	Trivalent Chromate	Fixing Pitch	20.8~25.4
Accessory	Bolt with Rubber Material NBR Hardness Shore A70	Suppress Pressure(N)	2352
Unit Price Qty. 1~19	11,48	Tare(g)	265

MC01-4S

RoHS

NEW

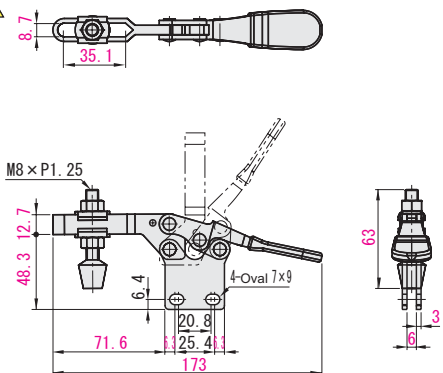

Bottom Holder/Horizontal Handle Type, Standard Handle, Long Handle

Part Number	HH150ZL	Open-Close Angle of Arm	95°
		Open-Close Angle of Handle	70°
Body Material	1.0040/Ust.42.2	Mounting Bolt	M4
Surface Treatment	Trivalent Chromate	Fixing Pitch	15.9×16
Accessory	*Nylon Bolt	Suppress Pressure(N)	264.6
Unit Price Qty. 1~9	12,00	Tare(g)	33

HH150ZL

*Not bolt with rubber.

RoHS

Old

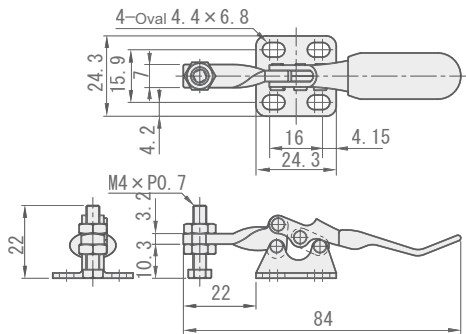

Part Number	HH250ZL	Open-Close Angle of Arm	95°
		Open-Close Angle of Handle	70°
Body Material	1.0040/Ust.42.2	Mounting Bolt	M4
Surface Treatment	Trivalent Chromate	Fixing Pitch	15.9×16
Accessory	*Nylon Bolt	Suppress Pressure(N)	264.6
Unit Price Qty. 1~9	12,00	Tare(g)	33

HH250ZL

*Not bolt with rubber.

RoHS

Old

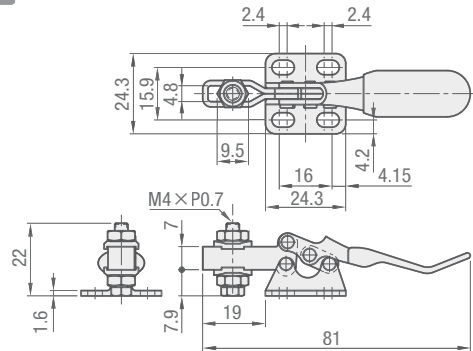

Part Number	HH350ZL	Open-Close Angle of Arm	90°
		Open-Close Angle of Handle	60°
Body Material	1.0040/Ust.42.2	Mounting Bolt	M5
Surface Treatment	Trivalent Chromate	Fixing Pitch	22.2×27
Accessory	Bolt with Rubber Material NBR Hardness Shore A70	Suppress Pressure(N)	882
Unit Price Qty. 1~9	16,20	Tare(g)	130

HH350ZL

RoHS

Old

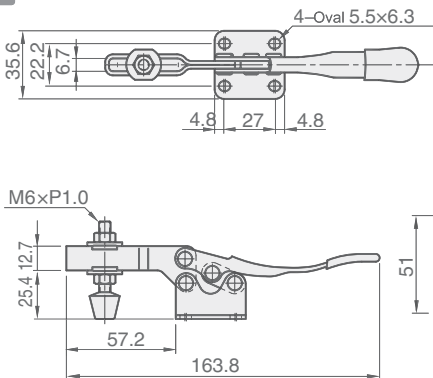

Part Number	MC01L-1	Open-Close Angle of Arm	90°
		Open-Close Angle of Handle	75°
Body Material	1.0040/Ust.42.2	Mounting Bolt	M4
Surface Treatment	Trivalent Chromate	Fixing Pitch	15.9×15.9
Accessory	*Nylon Bolt	Suppress Pressure(N)	264.6
Unit Price Qty. 1~19	9,60	Tare(g)	35

MC01L-1

*Not bolt with rubber.

RoHS

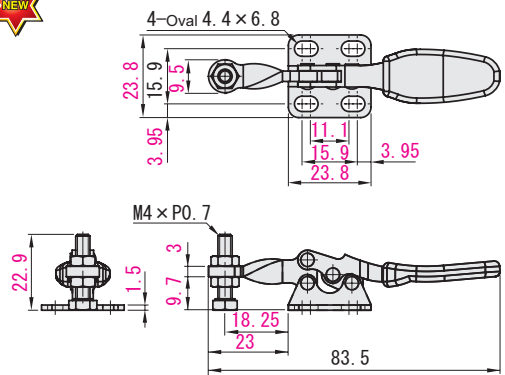

Part Number	MC01L-2	Open-Close Angle of Arm	90°
		Open-Close Angle of Handle	75°
Body Material	1.0040/Ust.42.2	Mounting Bolt	M4
Surface Treatment	Trivalent Chromate	Fixing Pitch	15.9×15.9
Accessory	*Nylon Bolt	Suppress Pressure(N)	264.6
Unit Price Qty. 1~19	9,60	Tare(g)	40

MC01L-2

*Not bolt with rubber.

RoHS

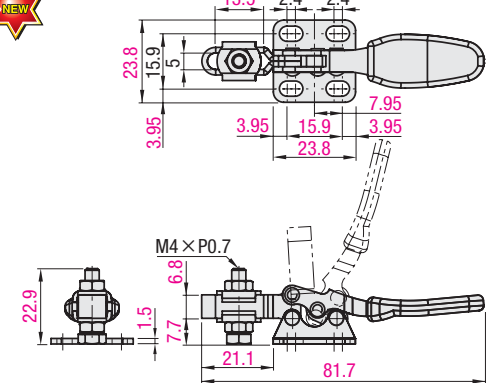

Part Number	MC01L-3	Open-Close Angle of Arm	85°
		Open-Close Angle of Handle	73°
Body Material	1.0040/Ust.42.2	Mounting Bolt	M5
Surface Treatment	Trivalent Chromate	Fixing Pitch	22×27
Accessory	Bolt with Rubber Material NBR Hardness Shore A70	Suppress Pressure(N)	882
Unit Price Qty. 1~19	12,15	Tare(g)	140

MC01L-3

RoHS

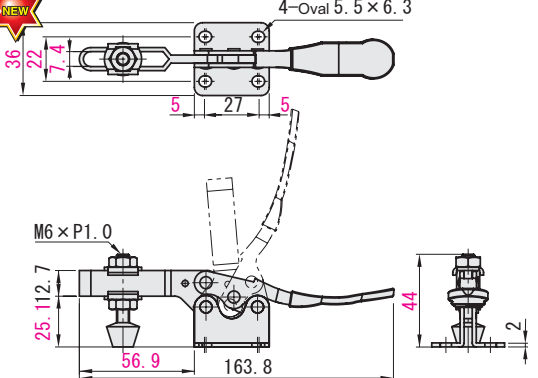

Horizontal Handle Type

Part Number	TC01		Open-Close Angle of Arm	70°
			Open-Close Angle of Handle	75°
Body Material	1.0040/Ust.42.2		Mounting Bolt	M4
Surface Treatment	Bright Chromate Plating		Fixing Pitch	19x14
Accessory	Stainless Steel Bolt		Suppress Pressure(N)	196
Unit Price Qty. 1~9	10,10		Tare(g)	30

TC01

Old

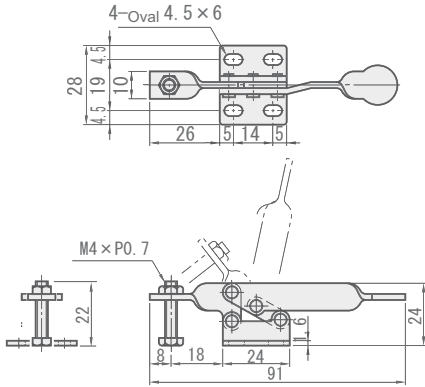

Part Number	TC04	STC04	Open-Close Angle of Arm	55°
			Open-Close Angle of Handle	60°
Body Material	1.0040/Ust.42.2	1.4301/X5CrNi18-10	Mounting Bolt	M4
Surface Treatment	Bright Chromate Plating	-	Fixing Pitch	15x13
Accessory	Stainless Steel Bolt	Stainless Steel Bolt	Suppress Pressure(N)	196
Unit Price Qty. 1~9	10,10	18,20	Tare(g)	30

TC04 STC04

Old

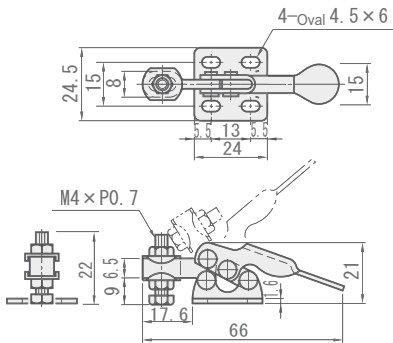

Part Number	TC03		Open-Close Angle of Arm	65°
			Open-Close Angle of Handle	55°
Body Material	1.0040/Ust.42.2		Mounting Bolt	M4
Surface Treatment	Bright Chromate Plating		Fixing Pitch	22x24
Accessory	Stainless Steel Bolt		Suppress Pressure(N)	294
Unit Price Qty. 1~9	11,40		Tare(g)	100

TC03

Old

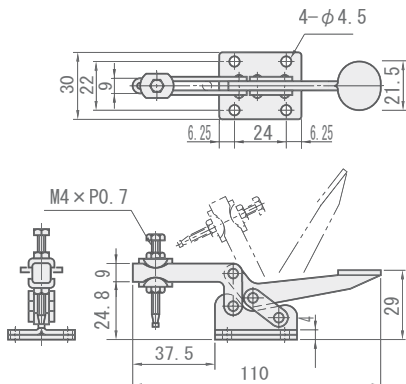

Part Number	MC01-5		Open-Close Angle of Arm	71°
			Open-Close Angle of Handle	72°
Body Material	1.0040/Ust.42.2		Mounting Bolt	M4
Surface Treatment	Trivalent Chromate		Fixing Pitch	19x14
Accessory	Stainless Steel Bolt		Suppress Pressure(N)	196
Unit Price Qty. 1~19	8,08		Tare(g)	30

MC01-5

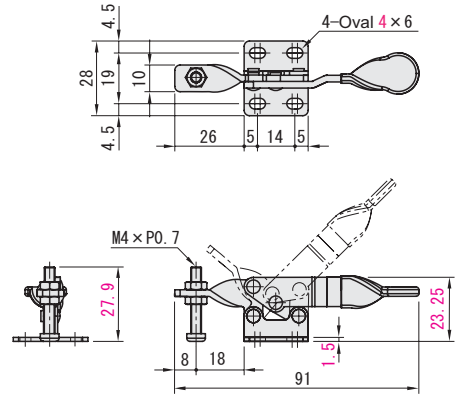

Part Number	MC01-6	MC01-S6	Open-Close Angle of Arm	75°
			Open-Close Angle of Handle	82°
Body Material	1.0040/Ust.42.2	1.4301/X5CrNi18-10	Mounting Bolt	M4
Surface Treatment	Trivalent Chromate	-	Fixing Pitch	15x15
Accessory	Stainless Steel Bolt	Stainless Steel Bolt	Suppress Pressure(N)	196
Unit Price Qty. 1~19	8,08	14,56	Tare(g)	30

MC01-6 MC01-S6

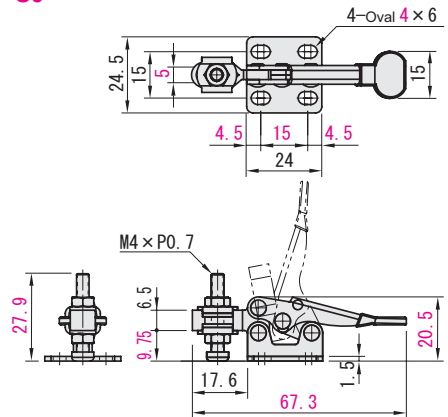

Part Number	MC01-7		Open-Close Angle of Arm	72°
			Open-Close Angle of Handle	74°
Body Material	1.0040/Ust.42.2		Mounting Bolt	M4
Surface Treatment	Trivalent Chromate		Fixing Pitch	22x24
Accessory	Stainless Steel Bolt		Suppress Pressure(N)	294
Unit Price Qty. 1~19	9,12		Tare(g)	100

MC01-7

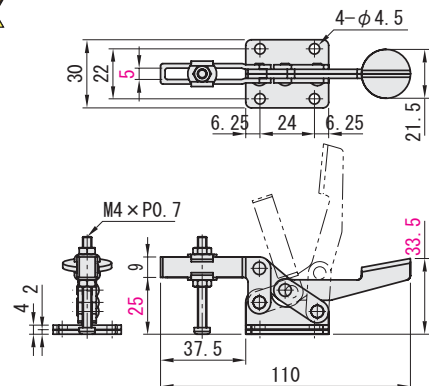

Horizontal Handle Type

Part Number	TC38BS	STC38BS	Open-Close Angle of Arm	75°
Body Material	1.0040/Ust.42.2	1.4301/XSC/Ni18-10	Open-Close Angle of Handle	70°
Surface Treatment	Bright Chromate Plating	-	Mounting Bolt	M8
Accessory	Stainless Steel Bolt	Stainless Steel Bolt	Fixing Pitch	34×24
Unit Price Qty. 1~9	13,80	30,00	Suppress Pressure(N)	2450
			Tare(g)	200

TC38BS STC38BS

Old

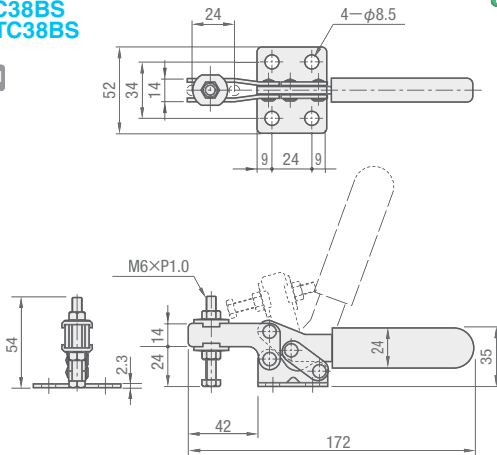

RoHS

Part Number	MC01-8	MC01-S8	Open-Close Angle of Arm	77°
Body Material	1.0040/Ust.42.2	1.4301/XSC/Ni18-10	Open-Close Angle of Handle	85°
Surface Treatment	Trivalent Chromate	-	Mounting Bolt	M8
Accessory	Stainless Steel Bolt	Stainless Steel Bolt	Fixing Pitch	34×24
Unit Price Qty. 1~19	11,04	22,50	Suppress Pressure(N)	2450
			Tare(g)	210

MC01-8 MC01-S8

NEW

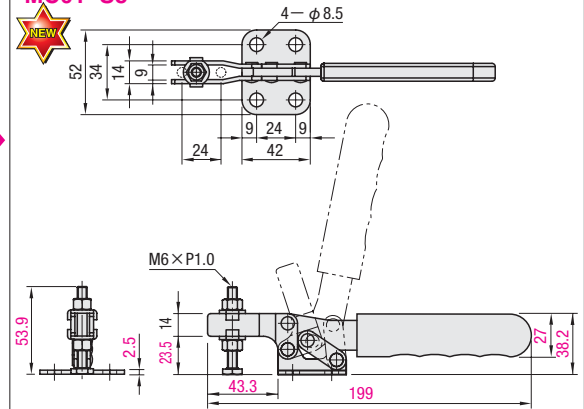

RoHS

Part Number	TC38BL	STC38BL	Open-Close Angle of Arm	80°
Body Material	1.0040/Ust.42.2	1.4301/XSC/Ni18-10	Open-Close Angle of Handle	80°
Surface Treatment	Bright Chromate Plating	-	Mounting Bolt	M10
Accessory	Stainless Steel Bolt	Stainless Steel Bolt	Fixing Pitch	37×30
Unit Price Qty. 1~9	17,00	46,00	Suppress Pressure(N)	2744
			Tare(g)	460

TC38BL STC38BL

Old

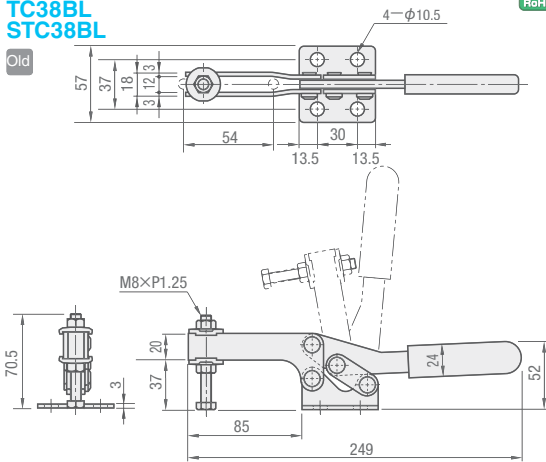

RoHS

Part Number	MC01-9	MC01-S9	Open-Close Angle of Arm	79°
Body Material	1.0040/Ust.42.2	1.4301/XSC/Ni18-10	Open-Close Angle of Handle	86°
Surface Treatment	Trivalent Chromate	-	Mounting Bolt	M10
Accessory	Stainless Steel Bolt	Stainless Steel Bolt	Fixing Pitch	37×30
Unit Price Qty. 1~19	13,60	36,80	Suppress Pressure(N)	2744
			Tare(g)	435

MC01-9 MC01-S9

NEW

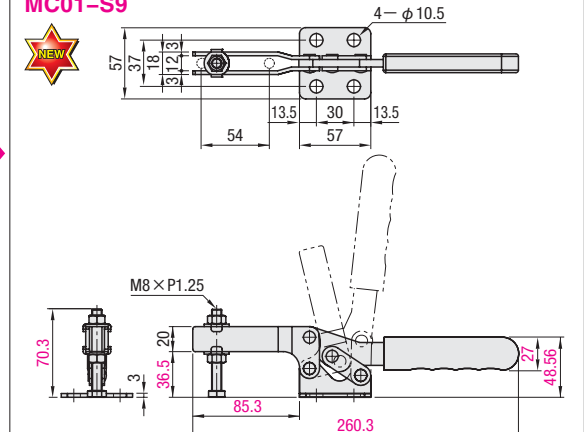

RoHS

Horizontal Handle Type(Straight Base)

Part Number	TC38BSK	Open-Close Angle of Arm	75°
Body Material	1.0040/Ust.42.2	Open-Close Angle of Handle	70°
Surface Treatment	Bright Chromate Plating	Mounting Bolt	M8
Accessory	Stainless Steel Bolt	Fixing Pitch	24
Unit Price Qty. 1~9	13,80	Suppress Pressure(N)	2450
		Tare(g)	200

TC38BSK

Old

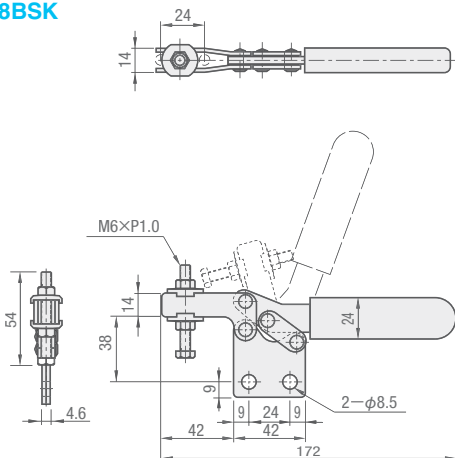

Part Number	MC01-8S	Open-Close Angle of Arm	77°
Body Material	1.0040/Ust.42.2	Open-Close Angle of Handle	85°
Surface Treatment	Trivalent Chromate	Mounting Bolt	M8
Accessory	Stainless Steel Bolt	Fixing Pitch	24
Unit Price Qty. 1~19	11,04	Suppress Pressure(N)	2450
		Tare(g)	210

MC01-8S

NEW

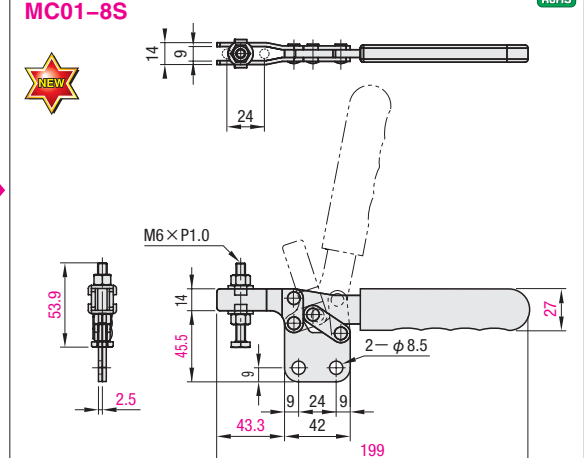

RoHS

Part Number	TSL10	STSL10	Open-Close Angle of Handle	180°
Body Material	1.0040/Ust.42.2	1.4301/XSC/Ni18-10	Mounting Bolt	M4
Surface Treatment	Bright Chromate Plating	-	Fixing Pitch	16x16
Stroke(mm)	16		Suppress Pressure(N)	450
Accessory	Bolt with Rubber	Stainless Steel Bolt		
Unit Price Qty. 1~9	9,70	24,50	Tare(g)	40

TSL10 STSL10

RoHS

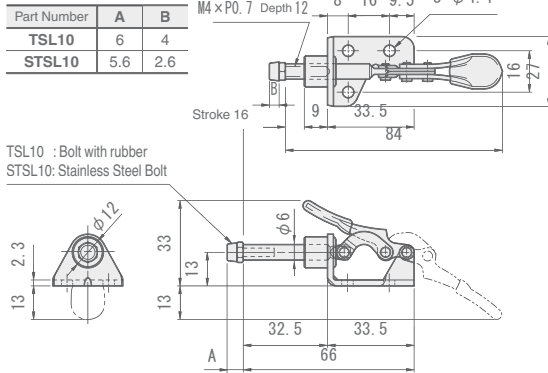

Part Number	TSL50L	TSL50R	Open-Close Angle of Handle	180°
Body Material	1.0040/Ust.42.2	1.4301/XSC/Ni18-10	Mounting Bolt	M4
Surface Treatment	Bright Chromate Plating	-	Fixing Pitch	16x16
Stroke(mm)	16		Suppress Pressure(N)	500
Accessory	Bolt with Rubber	Stainless Steel Bolt		
Unit Price Qty. 1~9	11,60		Tare(g)	60

TSL50L (Right Turn)

TSL50R (Left Turn)

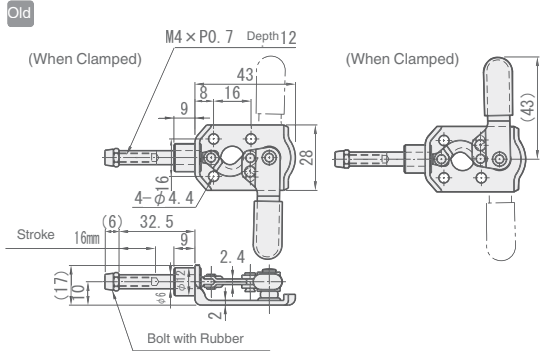

(Figure:Clamp condition)

Part Number	HV150	SHV150	Open-Close Angle of Arm	105°
Body Material	1.0040/Ust.42.2	1.4301/XSC/Ni18-10	Open-Close Angle of Handle	60°
Surface Treatment	Bright Chromate Plating	-	Mounting Bolt	M4
Accessory	Bolt with Nylon Finished Tip	Stainless Steel Bolt	Fixing Pitch	15.9x23.8
Unit Price Qty. 1~9	9,80	22,00	Suppress Pressure(N)	441
			Tare(g)	70

HV150 SHV150

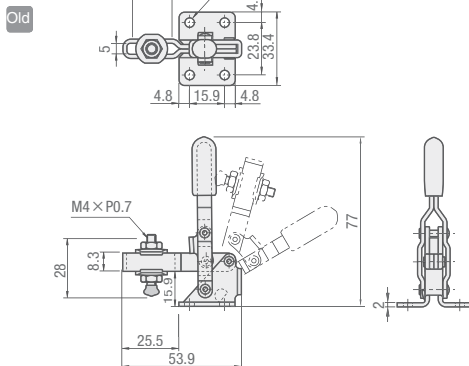

Part Number	MC03-1	MC03-S1	Open-Close Angle of Handle	190°
Body Material	1.0040/Ust.42.2	1.4301/XSC/Ni18-10	Mounting Bolt	M4
Surface Treatment	Trivalent Chromate	-	Fixing Pitch	15.9x15.9
Stroke(mm)	16		Suppress Pressure(N)	450
Accessory	Bolt with Rubber	Stainless Steel Bolt		
Unit Price Qty. 1~19	7,76	19,60	Tare(g)	50

MC03-1 MC03-S1



RoHS

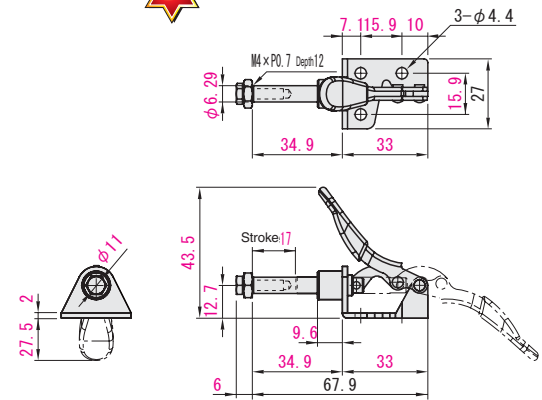

Part Number	MC03-2	MC03-3	Open-Close Angle of Handle	180°
Body Material	1.0040/Ust.42.2	1.4301/XSC/Ni18-10	Mounting Bolt	M4
Surface Treatment	Trivalent Chromate	-	Fixing Pitch	16x16
Stroke(mm)	16		Suppress Pressure(N)	500
Accessory	Bolt with Rubber	Stainless Steel Bolt		
Unit Price Qty. 1~19	9,28		Tare(g)	65

MC03-2 (Right Turn)

MC03-3 (Left Turn)

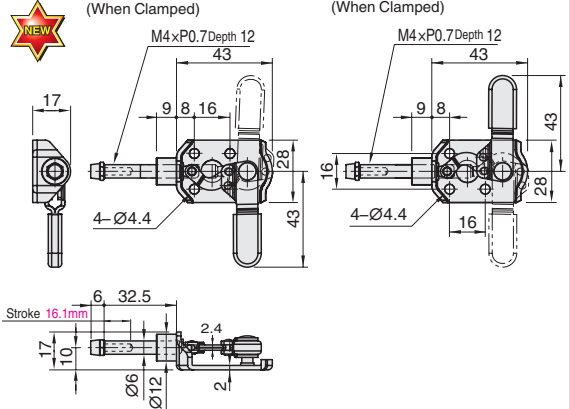

Part Number	MC04-1	MC04-S1	Open-Close Angle of Arm	100°
Body Material	1.0040/Ust.42.2	1.4301/XSC/Ni18-10	Open-Close Angle of Handle	56°
Surface Treatment	Trivalent Chromate	-	Mounting Bolt	M4
Accessory	Bolt with Rubber	Stainless Steel Bolt	Fixing Pitch	15.9x23.8
Unit Price Qty. 1~19	7,84	17,60	Suppress Pressure(N)	441
			Tare(g)	60

MC04-1 MC04-S1



RoHS

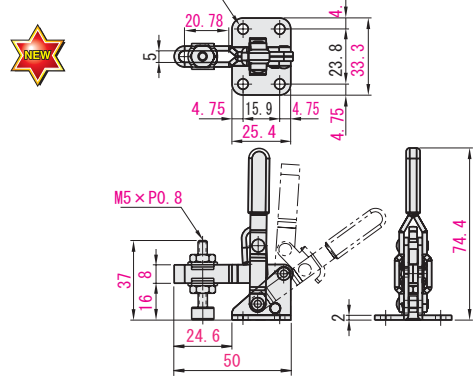

Part Number	HV250	SHV250	Open-Close Angle of Arm	115°
			Open-Close Angle of Handle	65°
Body Material	1.0040/Ust.42.2	1.4301/XSC/Ni18-10	Mounting Bolt	M5
Surface Treatment	Bright Chromate Plating	-	Fixing Pitch	12.7×27
Accessory	Bolt with Rubber Material NBR Hardness Shore A70	Stainless Steel Bolt	Suppress Pressure(N)	882
Unit Price Qty. 1~9	10,70	26,60	Tare(g)	170

HV250 SHV250

Old

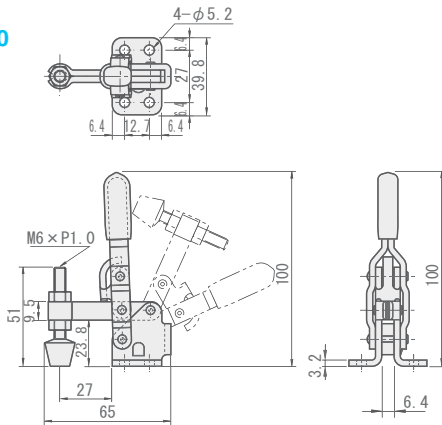

Part Number	HV450	SHV450	Open-Close Angle of Arm	100°
			Open-Close Angle of Handle	60°
Body Material	1.0040/Ust.42.2	1.4301/XSC/Ni18-10	Mounting Bolt	M6
Surface Treatment	Bright Chromate Plating	-	Fixing Pitch	19×31.8
Accessory	Bolt with Rubber Material NBR Hardness Shore A70	Stainless Steel Bolt	Suppress Pressure(N)	2205
Unit Price Qty. 1~9	13,80	34,80	Tare(g)	360

HV450 SHV450

Old

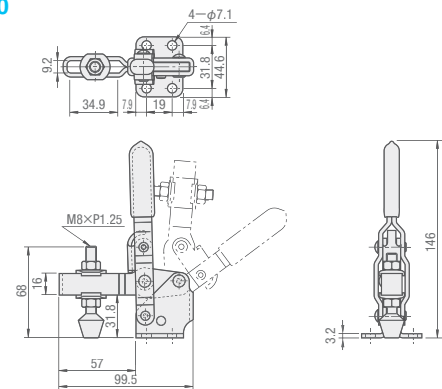

Part Number	HV650		Open-Close Angle of Arm	106°
			Open-Close Angle of Handle	58°
Body Material	1.0040/Ust.42.2		Mounting Bolt	M8
Surface Treatment	Bright Chromate Plating		Fixing Pitch	31.8×45.2
Accessory	Bolt with Rubber Material NBR Hardness Shore A70		Suppress Pressure(N)	3332
Unit Price Qty. 1~9	18,20		Tare(g)	600

HV650

Old

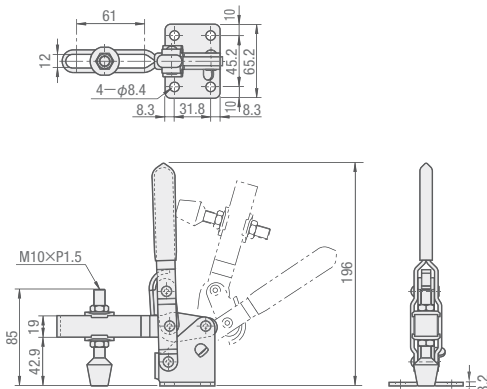

Part Number	MC04-2	MC04-S2	Open-Close Angle of Arm	95°
			Open-Close Angle of Handle	60°
Body Material	1.0040/Ust.42.2	1.4301/XSC/Ni18-10	Mounting Bolt	M5
Surface Treatment	Trivalent Chromate	-	Fixing Pitch	12.7×27
Accessory	Bolt with Rubber Material NBR Hardness Shore A70	Stainless Steel Bolt	Suppress Pressure(N)	882
Unit Price Qty. 1~19	8,56	19,95	Tare(g)	170

RoHS

MC04-2 MC04-S2

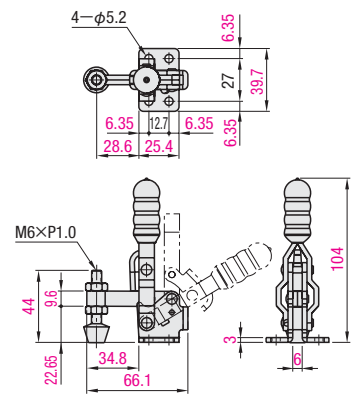

Part Number	MC04-3	MC04-S3	Open-Close Angle of Arm	95°
			Open-Close Angle of Handle	60°
Body Material	1.0040/Ust.42.2	1.4301/XSC/Ni18-10	Mounting Bolt	M6
Surface Treatment	Trivalent Chromate	-	Fixing Pitch	19×31.8
Accessory	Bolt with Rubber Material NBR Hardness Shore A70	Stainless Steel Bolt	Suppress Pressure(N)	2205
Unit Price Qty. 1~19	11,04	26,10	Tare(g)	355

RoHS

MC04-3 MC04-S3

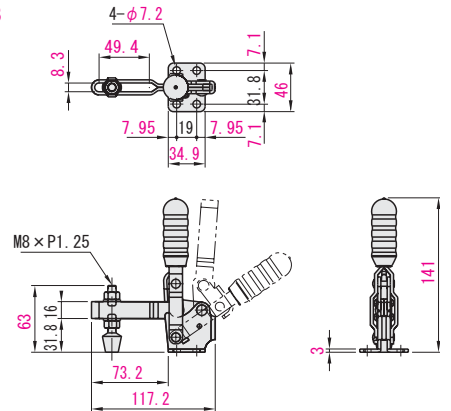

Part Number	MC04-4		Open-Close Angle of Arm	106°
			Open-Close Angle of Handle	58°
Body Material	1.0040/Ust.42.2		Mounting Bolt	M8
Surface Treatment	Trivalent Chromate		Fixing Pitch	31.8×45.3
Accessory	Bolt with Rubber Material NBR Hardness Shore A70		Suppress Pressure(N)	3332
Unit Price Qty. 1~19	16,38		Tare(g)	635

RoHS

MC04-4

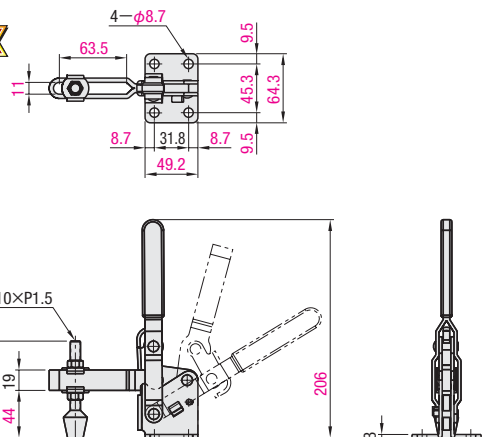

Part Number	HV150S	Open-Close Angle of Arm	105°
		Open-Close Angle of Handle	60°
Body Material	1.0040/Ust.42.2	Mounting Bolt	M4
Surface Treatment	Trivalent Chromate	Fixing Pitch	15.9
Accessory	Bolt with Nylon Finished Tip	Suppress Pressure(N)	441
Unit Price Qty. 1~9	10,50	Tare(g)	70

HV150S (Straight Base)

Old

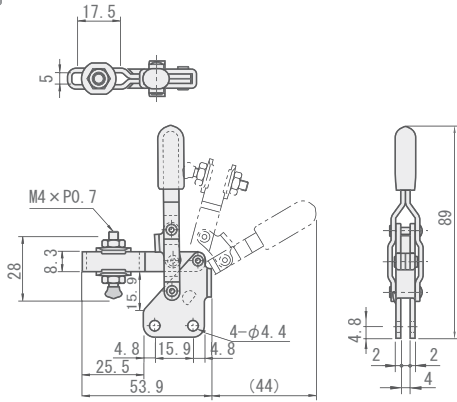

RoHS

Part Number	MC04-1S	Open-Close Angle of Arm	100°
		Open-Close Angle of Handle	56°
Body Material	1.0040/Ust.42.2	Mounting Bolt	M4
Surface Treatment	Trivalent Chromate	Fixing Pitch	15.9
Accessory	Bolt with Rubber	Suppress Pressure(N)	441
Unit Price Qty. 1~19	8,40	Tare(g)	60

MC04-1S

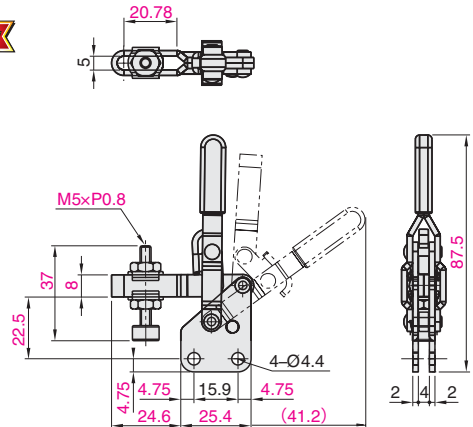

RoHS

Part Number	HV250S	Open-Close Angle of Arm	115°
		Open-Close Angle of Handle	65°
Body Material	1.0040/Ust.42.2	Mounting Bolt	M5
Surface Treatment	Trivalent Chromate	Fixing Pitch	12.7
Accessory	Bolt with Rubber Material NBR Hardness Shore A70	Suppress Pressure(N)	882
Unit Price Qty. 1~9	11,40	Tare(g)	170

HV250S (Straight Base)

Old

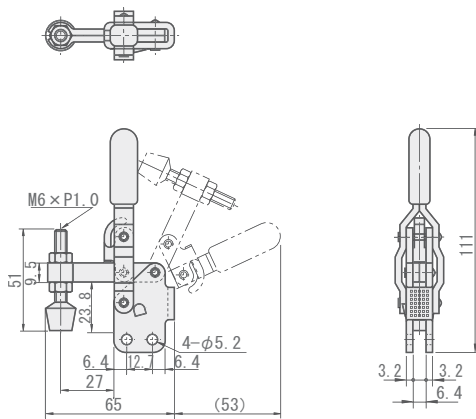

RoHS

Part Number	MC04-2S	Open-Close Angle of Arm	95°
		Open-Close Angle of Handle	60°
Body Material	1.0040/Ust.42.2	Mounting Bolt	M5
Surface Treatment	Trivalent Chromate	Fixing Pitch	12.7
Accessory	Bolt with Rubber Material NBR Hardness Shore A70	Suppress Pressure(N)	882
Unit Price Qty. 1~19	9,12	Tare(g)	170

MC04-2S

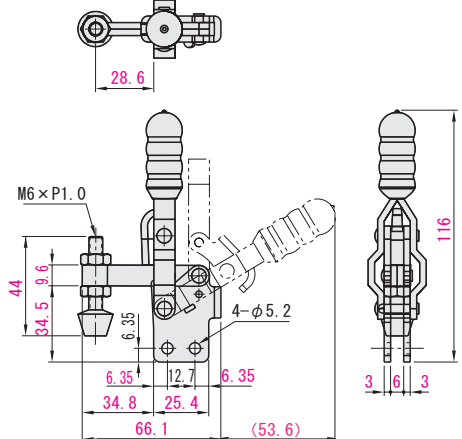

RoHS

Part Number	HV450S	Open-Close Angle of Arm	100°
		Open-Close Angle of Handle	60°
Body Material	1.0040/Ust.42.2	Mounting Bolt	M6
Surface Treatment	Trivalent Chromate	Fixing Pitch	19
Accessory	Bolt with Rubber Material NBR Hardness Shore A70	Suppress Pressure(N)	2205
Unit Price Qty. 1~9	14,50	Tare(g)	360

HV450S (Straight Base)

Old

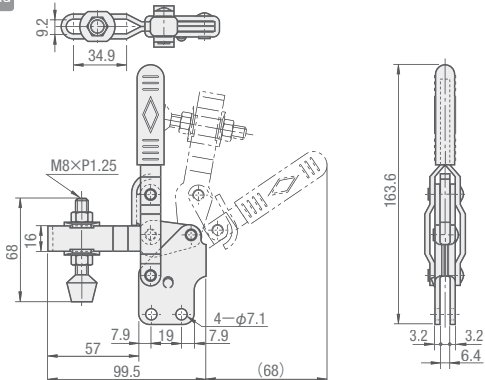

RoHS

Part Number	MC04-3S	Open-Close Angle of Arm	100°
		Open-Close Angle of Handle	56°
Body Material	1.0040/Ust.42.2	Mounting Bolt	M6
Surface Treatment	Trivalent Chromate	Fixing Pitch	19
Accessory	Bolt with Rubber Material NBR Hardness Shore A70	Suppress Pressure(N)	2205
Unit Price Qty. 1~19	11,60	Tare(g)	355

MC04-3S

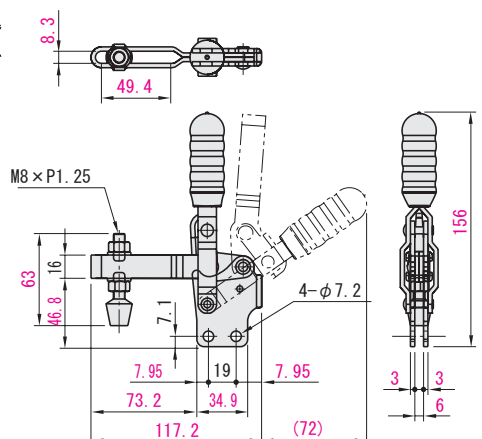

RoHS

Part Number	HV650S	Open-Close Angle of Arm	106°
		Open-Close Angle of Handle	58°
Body Material	1.0040/Ust.42.2	Mounting Bolt	M8
Surface Treatment	Trivalent Chromate	Fixing Pitch	31.8
Accessory	Bolt with Rubber Material NBR Hardness Shore A70	Suppress Pressure(N)	3332
Unit Price Qty. 1~9	19,70	Tare(g)	600

HV650S (Straight Base)

RoHS

Old

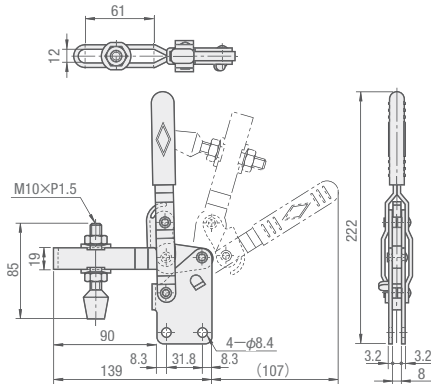

Part Number	MC04-4S	Open-Close Angle of Arm	112°
		Open-Close Angle of Handle	61°
Body Material	1.0040/Ust.42.2	Mounting Bolt	M8
Surface Treatment	Trivalent Chromate	Fixing Pitch	31.8
Accessory	Bolt with Rubber Material NBR Hardness Shore A70	Suppress Pressure(N)	3332
Unit Price Qty. 1~19	17,73	Tare(g)	635

MC04-4S

RoHS

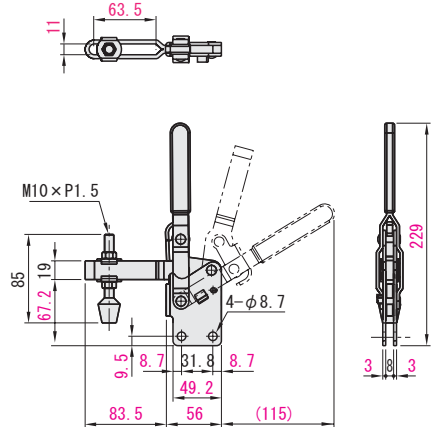

Bottom Holder, Vertical Handle Type (Long Arm)

Part Number	HV150L	Open-Close Angle of Arm	105°
		Open-Close Angle of Handle	60°
Body Material	1.0040/Ust.42.2	Mounting Bolt	M4
Surface Treatment	Bright Chromate Plating	Fixing Pitch	23.8x15.9
Accessory	Bolt with Nylon Finished Tip	Suppress Pressure(N)	186
Unit Price Qty. 1~9	13,80	Tare(g)	75

HV150L (Long Arm)

Old

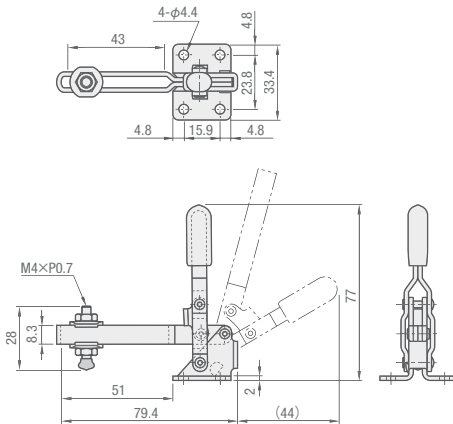

Part Number	MC04-1L	Open-Close Angle of Arm	100°
		Open-Close Angle of Handle	56°
Body Material	1.0040/Ust.42.2	Mounting Bolt	M4
Surface Treatment	Trivalent Chromate	Fixing Pitch	23.8x15.9
Accessory	Bolt with Rubber	Suppress Pressure(N)	186
Unit Price Qty. 1~19	11,04	Tare(g)	75

MC04-1L

RoHS

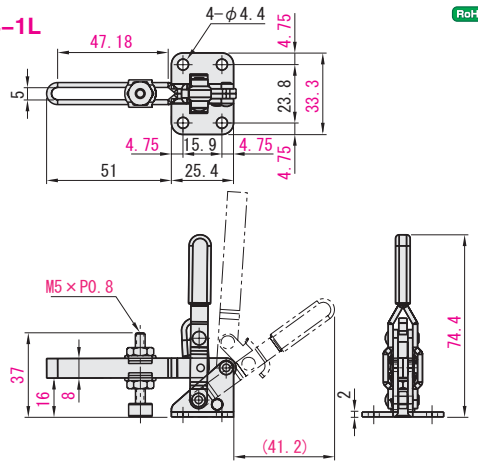

Part Number	HV250L	Open-Close Angle of Arm	115°
		Open-Close Angle of Handle	65°
Body Material	1.0040/Ust.42.2	Mounting Bolt	M5
Surface Treatment	Bright Chromate Plating	Fixing Pitch	27x12.7
Accessory	Bolt with Rubber Material NBR Hardness Shore A70	Suppress Pressure(N)	392
Unit Price Qty. 1~9	12,30	Tare(g)	175

HV250L (Long Arm)

Old

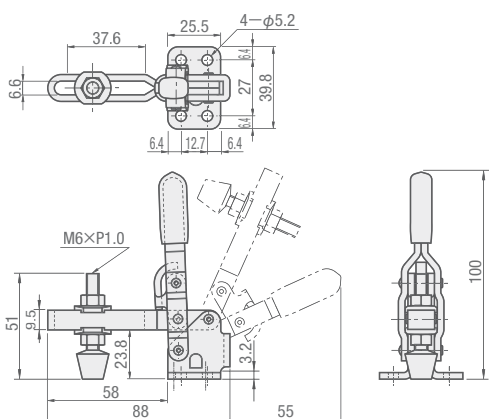

Part Number	MC04-2L	Open-Close Angle of Arm	95°
		Open-Close Angle of Handle	60°
Body Material	1.0040/Ust.42.2	Mounting Bolt	M5
Surface Treatment	Trivalent Chromate	Fixing Pitch	27x12.7
Accessory	Bolt with Rubber Material NBR Hardness Shore A70	Suppress Pressure(N)	392
Unit Price Qty. 1~19	10,46	Tare(g)	175

MC04-2L

RoHS

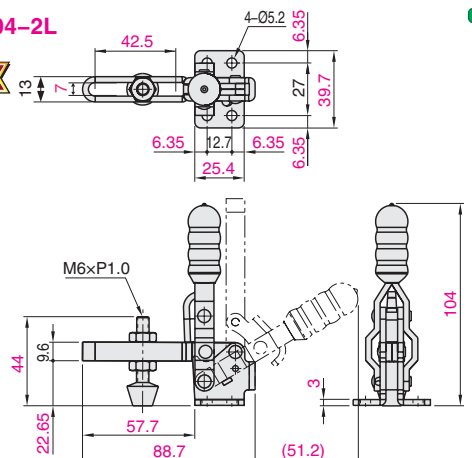

Part Number	HV450L	Open-Close Angle of Arm	100°
		Open-Close Angle of Handle	60°
Body Material	1.0040/Ust.42.2	Mounting Bolt	M6
Surface Treatment	Bright Chromate Plating	Fixing Pitch	31.8×19
Accessory	Bolt with Rubber Material NBR Hardness Shore A70	Suppress Pressure(N)	784
Unit Price Qty. 1~9	19.90	Tare(g)	400

HV450L (Long Arm)

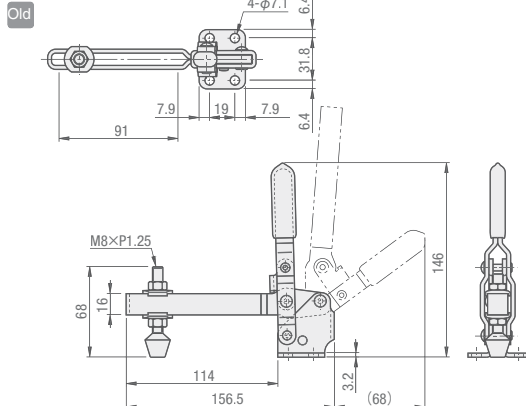

Part Number	HV650L	Open-Close Angle of Arm	106°
		Open-Close Angle of Handle	58°
Body Material	1.0040/Ust.42.2	Mounting Bolt	M8
Surface Treatment	Trivalent Chromate	Fixing Pitch	45.2×31.8
Accessory	Bolt with Rubber Material NBR Hardness Shore A70	Suppress Pressure(N)	1078
Unit Price Qty. 1~9	26.50	Tare(g)	780

HV650L (Long Arm)

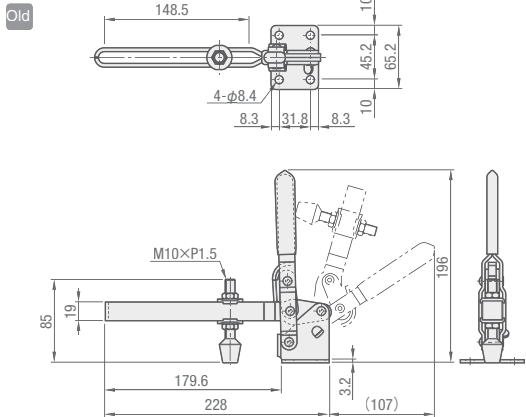

Vertical Handle Type

Part Number	TC09	STC09	Open-Close Angle of Arm	80°
			Open-Close Angle of Handle	88°
Body Material	1.0040/Ust.42.2	1.4301/XSC/Ni18-10	Mounting Bolt	M4
Surface Treatment	Bright Chromate Plating	-	Fixing Pitch	19.5×11.5
Accessory	Bolt with Rubber Material NBR Hardness Shore A70	-	Suppress Pressure(N)	294
Unit Price Qty. 1~9	10.90	19.60	Tare(g)	40

TC09 STC09

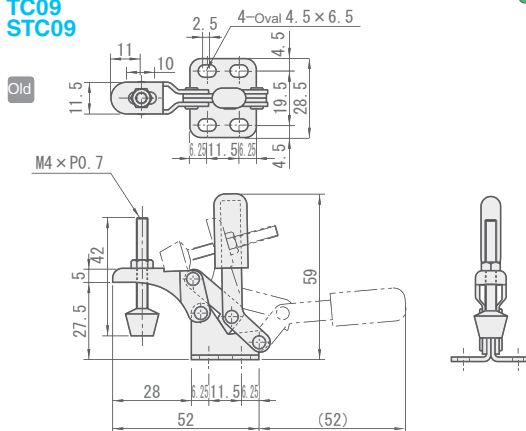

Part Number	MC04-3L	Open-Close Angle of Arm	100°
		Open-Close Angle of Handle	56°
Body Material	1.0040/Ust.42.2	Mounting Bolt	M6
Surface Treatment	Trivalent Chromate	Fixing Pitch	31.8×19
Accessory	Bolt with Rubber Material NBR Hardness Shore A70	Suppress Pressure(N)	784
Unit Price Qty. 1~19	15.92	Tare(g)	370

MC04-3L

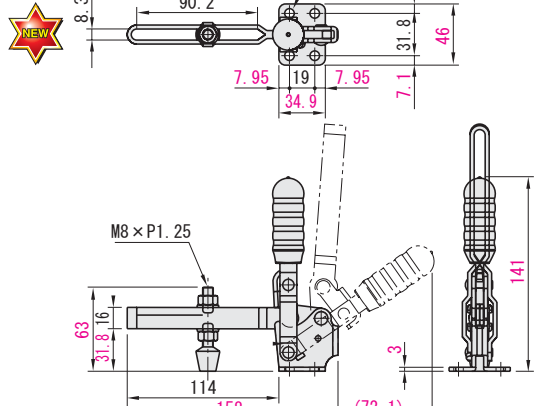

Part Number	MC04-4L	Open-Close Angle of Arm	112°
		Open-Close Angle of Handle	61°
Body Material	1.0040/Ust.42.2	Mounting Bolt	M8
Surface Treatment	Trivalent Chromate	Fixing Pitch	45.3×31.8
Accessory	Bolt with Rubber Material NBR Hardness Shore A70	Suppress Pressure(N)	1078
Unit Price Qty. 1~19	21.20	Tare(g)	815

MC04-4L

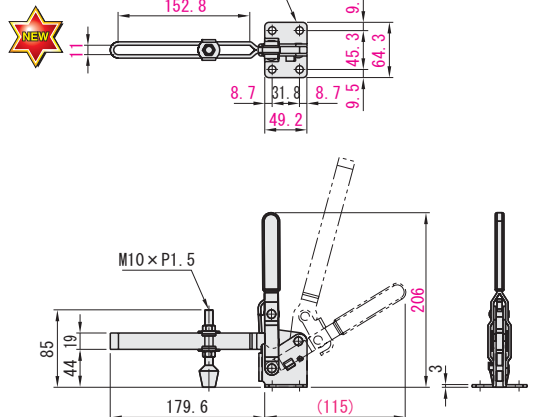

Part Number	MC04-6	MC04-S6	Open-Close Angle of Arm	80°
			Open-Close Angle of Handle	88°
Body Material	1.0040/Ust.42.2	1.4301/XSC/Ni18-10	Mounting Bolt	M4
Surface Treatment	Trivalent Chromate	-	Fixing Pitch	19.5×9~14
Accessory	Bolt with Rubber Material NBR Hardness Shore A70	Stainless Steel Bolt	Suppress Pressure(N)	294
Unit Price Qty. 1~19	8.72	14.70	Tare(g)	40

MC04-6 MC04-S6

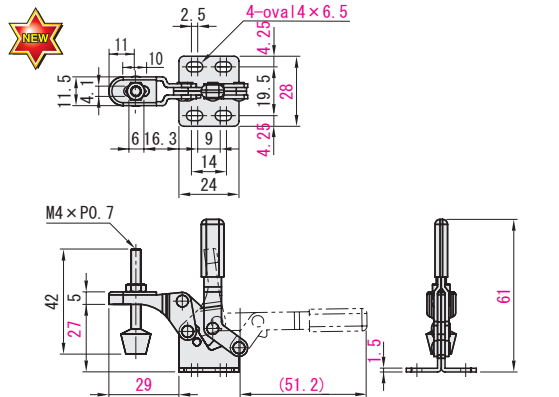

Part Number	TC40A	STC40A	Open-Close Angle of Arm	95°
			Open-Close Angle of Handle	65°
Body Material	1.0040/Ust.42.2	1.4301/X5CrNi18-10	Mounting Bolt	M6
Surface Treatment	Bright Chromate Plating	-	Fixing Pitch	30x18
Accessory	Steel Bolt	Stainless Steel Bolt	Suppress Pressure(N)	980
Unit Price Qty. 1~9	11,50	25,00	Tare(g)	200

TC40A STC40A

Old

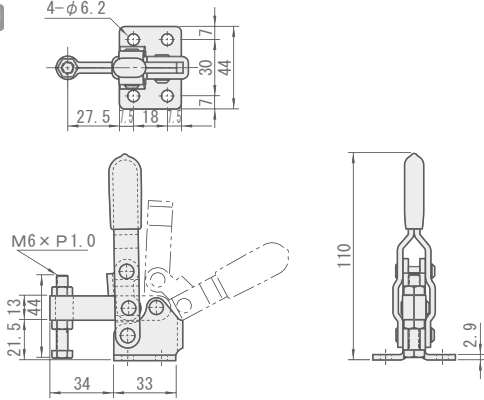

RoHS

Part Number	MC04-7	MC04-S7	Open-Close Angle of Arm	120°
			Open-Close Angle of Handle	72°
Body Material	1.0040/Ust.42.2	1.4301/X5CrNi18-10	Mounting Bolt	M6
Surface Treatment	Tivalent Chromate	-	Fixing Pitch	30x18
Accessory	Steel Bolt	Stainless Steel Bolt	Suppress Pressure(N)	980
Unit Price Qty. 1~19	9,78	21,25	Tare(g)	200

MC04-7 MC04-S7

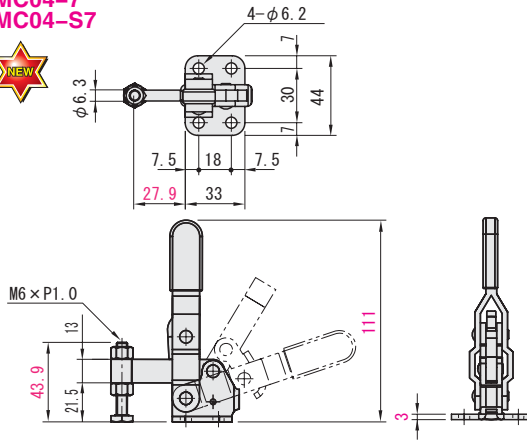

RoHS

Part Number	TC42A	STC42A	Open-Close Angle of Arm	94°
			Open-Close Angle of Handle	54°
Body Material	1.0040/Ust.42.2	1.4301/X5CrNi18-10	Mounting Bolt	M8
Surface Treatment	Bright Chromate Plating	-	Fixing Pitch	33x24
Accessory	Steel Bolt	Stainless Steel Bolt	Suppress Pressure(N)	1470
Unit Price Qty. 1~9	13,40	31,00	Tare(g)	390

TC42A STC42A

Old

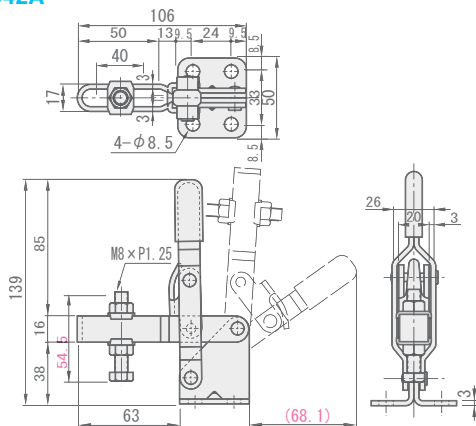

Part Number	MC04-8	MC04-S8	Open-Close Angle of Arm	94°
			Open-Close Angle of Handle	54°
Body Material	1.0040/Ust.42.2	1.4301/X5CrNi18-10	Mounting Bolt	M8
Surface Treatment	Tivalent Chromate	-	Fixing Pitch	33x24
Accessory	Steel Bolt	Stainless Steel Bolt	Suppress Pressure(N)	1470
Unit Price Qty. 1~19	12,06	26,35	Tare(g)	370

MC04-8 MC04-S8

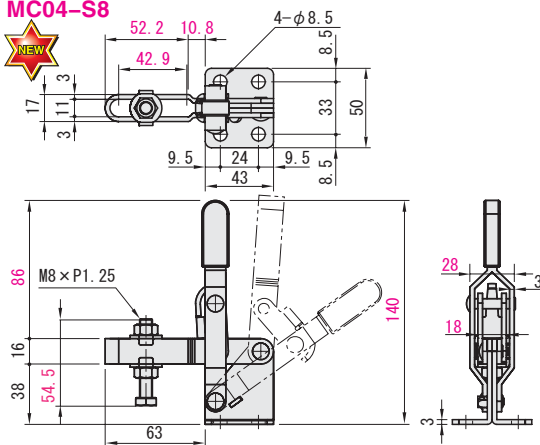

RoHS

Part Number	TC41BS	Open-Close Angle of Arm	110°
		Open-Close Angle of Handle	64°
Body Material	1.0040/Ust.42.2	Mounting Bolt	M6
Surface Treatment	Bright Chromate Plating	Fixing Pitch	48x17
Accessory	Steel Bolt	Suppress Pressure(N)	1960
Unit Price Qty. 1~9	17,60	Tare(g)	385

TC41BS

Old

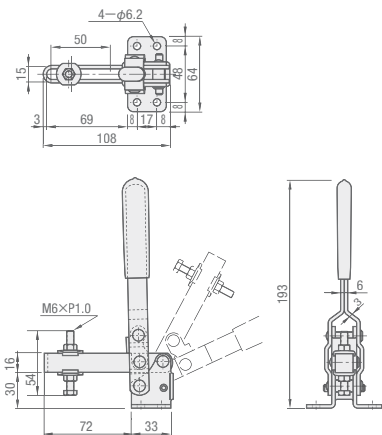

Part Number	MC04-9	Open-Close Angle of Arm	110°
		Open-Close Angle of Handle	64°
Body Material	1.0040/Ust.42.2	Mounting Bolt	M6
Surface Treatment	Tivalent Chromate	Fixing Pitch	48x17
Accessory	Steel Bolt	Suppress Pressure(N)	1960
Unit Price Qty. 1~19	15,84	Tare(g)	420

MC04-9

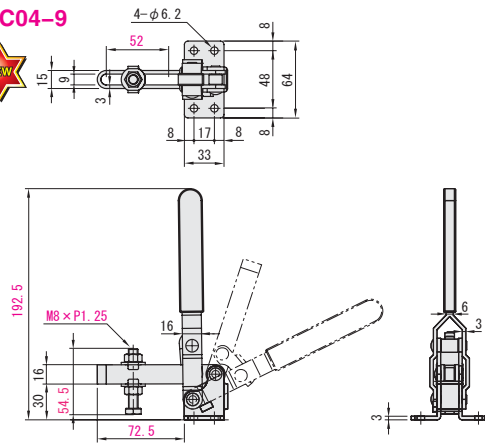

RoHS

Part Number	TC09S	Open-Close Angle of Arm	80°
		Open-Close Angle of Handle	88°
Body Material	1.0040/Ust.42.2	Mounting Bolt	M4
Surface Treatment	Bright Chromate Plating	Fixing Pitch	11.5
Accessory	Bolt with Rubber Material NBR Hardness Shore A70	Suppress Pressure(N)	294
Unit Price Qty. 1~9	10,90	Tare(g)	40

TC09S (Straight Base)

Old

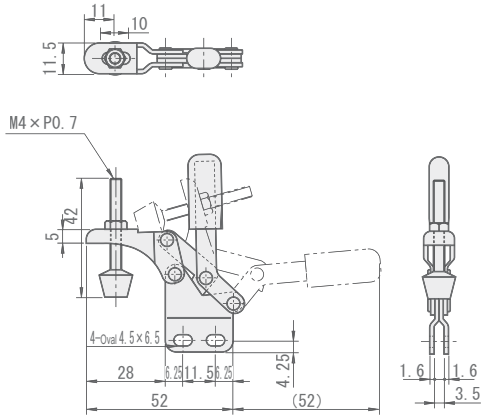

Part Number	TC40K	Open-Close Angle of Arm	95°
		Open-Close Angle of Handle	65°
Body Material	1.0040/Ust.42.2	Mounting Bolt	M8
Surface Treatment	Bright Chromate Plating	Fixing Pitch	18
Accessory	Steel Bolt	Suppress Pressure(N)	980
Unit Price Qty. 1~9	11,50	Tare(g)	200

TC40K (Straight Base)

Old

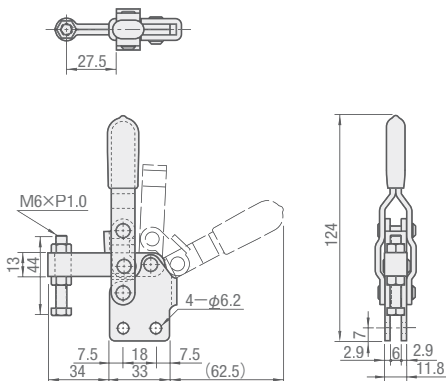

Part Number	TC42K	Open-Close Angle of Arm	94°
		Open-Close Angle of Handle	54°
Body Material	1.0040/Ust.42.2	Mounting Bolt	M8
Surface Treatment	Bright Chromate Plating	Fixing Pitch	24
Accessory	Steel Bolt	Suppress Pressure(N)	1470
Unit Price Qty. 1~9	13,40	Tare(g)	390

TC42K (Straight Base)

Old

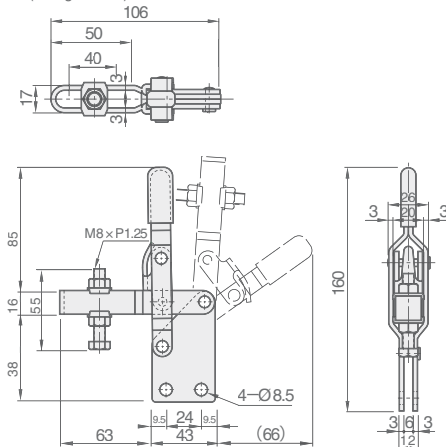

Part Number	MC04-6S	Open-Close Angle of Arm	80°
		Open-Close Angle of Handle	88°
Body Material	1.0040/Ust.42.2	Mounting Bolt	M4
Surface Treatment	Trivalent Chromate	Fixing Pitch	9~14
Accessory	Bolt with Rubber Material NBR Hardness Shore A70	Suppress Pressure(N)	294
Unit Price Qty. 1~19	8,72	Tare(g)	40

MC04-6S

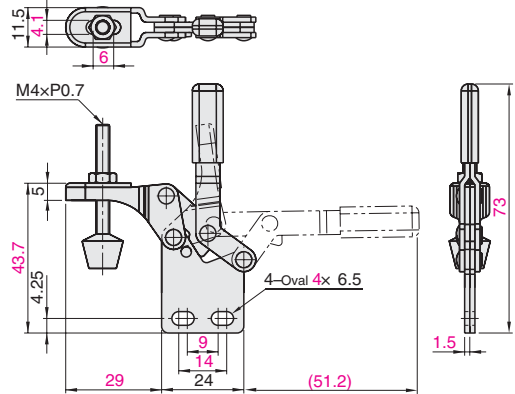

RoHS

Part Number	MC04-7S	Open-Close Angle of Arm	120°
		Open-Close Angle of Handle	72°
Body Material	1.0040/Ust.42.2	Mounting Bolt	M8
Surface Treatment	Trivalent Chromate	Fixing Pitch	18
Accessory	Steel Bolt	Suppress Pressure(N)	980
Unit Price Qty. 1~19	9,78	Tare(g)	200

MC04-7S

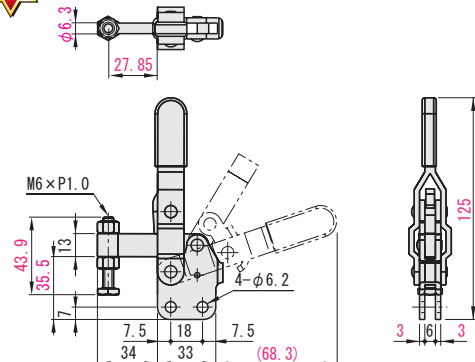

RoHS

Part Number	MC04-8S	Open-Close Angle of Arm	94°
		Open-Close Angle of Handle	54°
Body Material	1.0040/Ust.42.2	Mounting Bolt	M8
Surface Treatment	Trivalent Chromate	Fixing Pitch	24
Accessory	Steel Bolt	Suppress Pressure(N)	1470
Unit Price Qty. 1~19	12,06	Tare(g)	370

MC04-8S

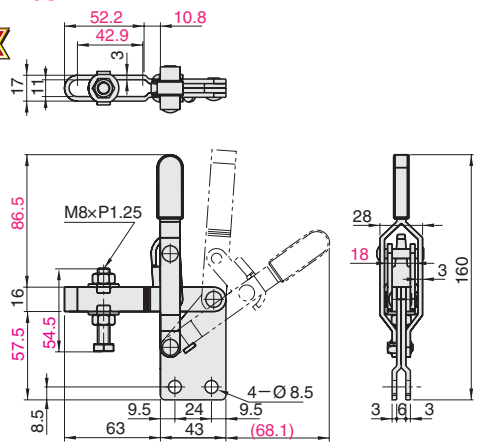

RoHS

Part Number	TC41BSS	Open-Close Angle of Arm	110°
		Open-Close Angle of Handle	64°
Body Material	1.0040/Ust.42.2	Mounting Bolt	M6
Surface Treatment	Bright Chromate Plating	Fixing Pitch	33
Accessory	Steel Bolt	Suppress Pressure(N)	1960
Unit Price Qty. 1~9	17,60	Tare(g)	385

TC41BSS (Straight Base)

Old

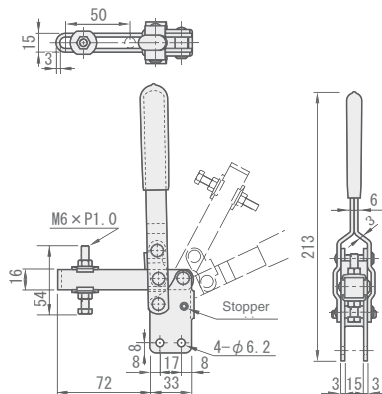

Part Number	LN2B	Open-Close Angle of Arm	110°
		Open-Close Angle of Handle	90°
Body Material	1.0040/Ust.42.2	Mounting Bolt	M10
Surface Treatment	Bright Chromate Plating	Fixing Pitch	55x35
Accessory	Steel Bolt	Suppress Pressure(N)	1000 ~ 3700
Unit Price Qty. 1~9	70,00	Tare(g)	1500

LN2B (Long Arm Type)

Old

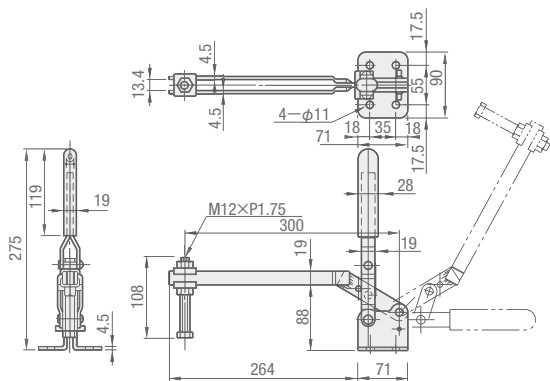

Part Number	FT2	Open-Close Angle of Arm	140°
		Open-Close Angle of Handle	67°
Body Material	1.0040/Ust.42.2	Mounting Bolt	M8
Surface Treatment	Bright Chromate Plating	Fixing Pitch	77x30
Accessory	Bolt with Rubber Material NBR Hardness Shore A70	Suppress Pressure(N)	800 ~ 1500
		Tare(g)	2000
Unit Price Qty. 1~9	72,00	Right and Left Travel Distance (mm)	40 ~ 80
		Back and Forth Travel Distance (mm)	60

FT2 (2-Pronged Type)

Old

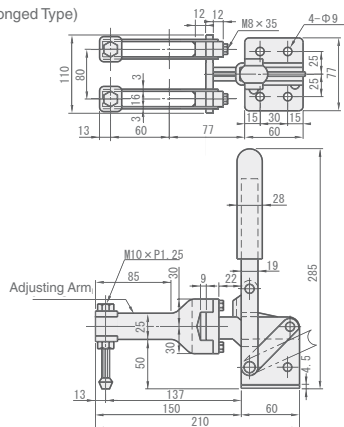

Part Number	MC04-9S	Open-Close Angle of Arm	110°
		Open-Close Angle of Handle	64°
Body Material	1.0040/Ust.42.2	Mounting Bolt	M6
Surface Treatment	Trivalent Chromate	Fixing Pitch	33
Accessory	Steel Bolt	Suppress Pressure(N)	1960
Unit Price Qty. 1~19	15,84	Tare(g)	420

MC04-9S

RoHS

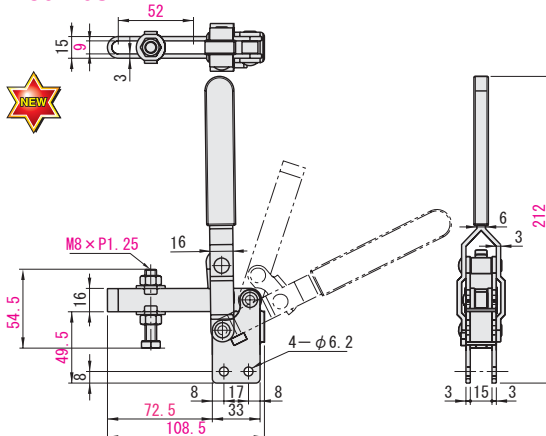

Part Number	MC06-1	Open-Close Angle of Arm	110°
		Open-Close Angle of Handle	90°
Body Material	1.0040/Ust.42.2	Mounting Bolt	M10
Surface Treatment	Trivalent Chromate	Fixing Pitch	55x35
Accessory	Steel Bolt	Suppress Pressure(N)	1000 ~ 3700
Unit Price Qty. 1~19	52,50	Tare(g)	1500

MC06-1 (Long Arm Type)

RoHS

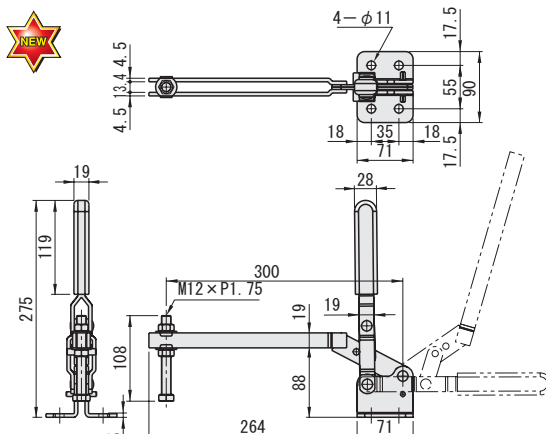

Part Number	MC05-1	Open-Close Angle of Arm	140°
		Open-Close Angle of Handle	74°
Body Material	1.0040/Ust.42.2	Mounting Bolt	M10
Surface Treatment	Trivalent Chromate	Fixing Pitch	77x30
Accessory	Bolt with Rubber Material NBR Hardness Shore A70	Suppress Pressure(N)	800 ~ 1500
		Tare(g)	2000
Unit Price Qty. 1~19	54,00	Right and Left Travel Distance (mm)	40 ~ 80
		Back and Forth Travel Distance (mm)	60

MC05-1 (2-Pronged Type)

RoHS

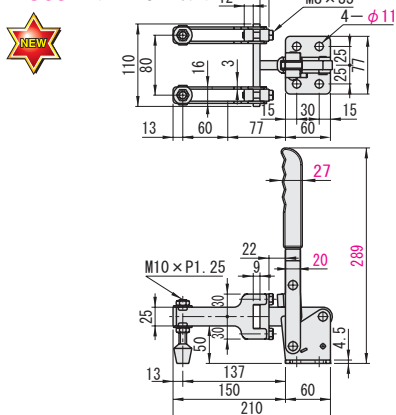

Push-Pull Type

Part Number	TC06	Open-Close Angle of Handle	93°
Body Material	1.0040/Ust.42.2	Mounting Bolt	M5
Surface Treatment	Bright Chromate Plating	Fixing Pitch	25.3×14
Unit Price Qty. 1~9	10,48	Suppress Pressure(N)	490
		Tare(g)	70
		Stroke(mm)	13

TC06

Old

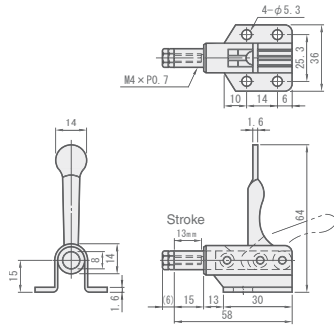

Part Number	TC07	Open-Close Angle of Handle	66°
Body Material	1.0040/Ust.42.2	Mounting Bolt	M5
Surface Treatment	Bright Chromate Plating	Fixing Pitch	28×24
Unit Price Qty. 1~9	10,56	Suppress Pressure(N)	500
		Tare(g)	100
		Stroke(mm)	10

TC07

Old

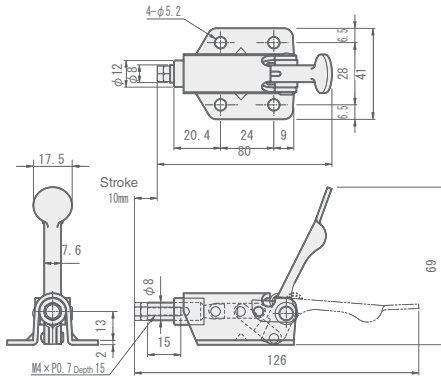

Part Number	TC02	Open-Close Angle of Handle	150°
Body Material	1.0040/Ust.42.2	Mounting Bolt	M6
Surface Treatment	Bright Chromate Plating	Fixing Pitch	34×40
Unit Price Qty. 1~9	13,04	Suppress Pressure(N)	1960
		Tare(g)	370
		Stroke(mm)	30

TC02

Old

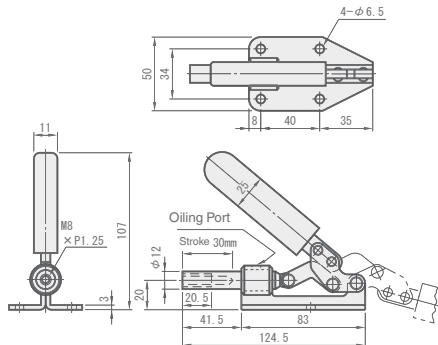

Part Number	MC07-1	Open-Close Angle of Handle	93°
Body Material	1.0040/Ust.42.2	Mounting Bolt	M5
Surface Treatment	Trivalent Chromate	Fixing Pitch	25.3×14
Unit Price Qty. 1~19	9,43	Suppress Pressure(N)	490
		Tare(g)	70
		Stroke(mm)	13.6

MC07-1

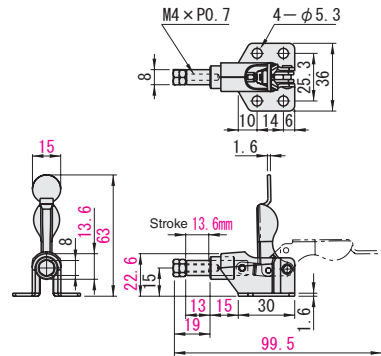

RoHS

Part Number	MC07-2	Open-Close Angle of Handle	66°
Body Material	1.0040/Ust.42.2	Mounting Bolt	M5
Surface Treatment	Trivalent Chromate	Fixing Pitch	28×24
Unit Price Qty. 1~19	9,50	Suppress Pressure(N)	500
		Tare(g)	100
		Stroke(mm)	10

MC07-2

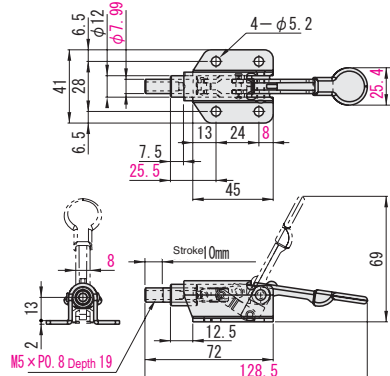

RoHS

Part Number	MC07-3	Open-Close Angle of Handle	140°
Body Material	1.0040/Ust.42.2	Mounting Bolt	M6
Surface Treatment	Trivalent Chromate	Fixing Pitch	34×40
Unit Price Qty. 1~19	11,74	Suppress Pressure(N)	1960
		Tare(g)	370
		Stroke(mm)	30

MC07-3

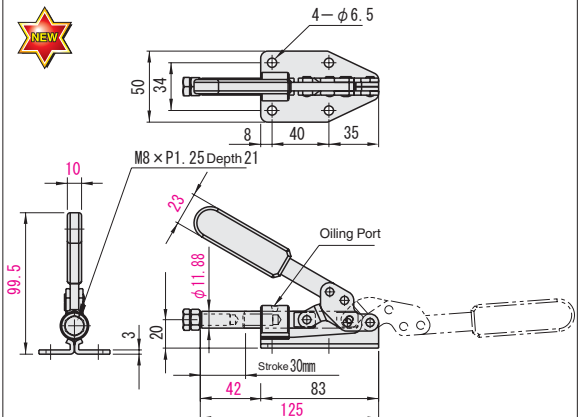

RoHS

Part Number	TC51BS	Open-Close Angle of Handle	45°
Body Material	1.0040/Ust.42.2	Mounting Bolt	M6
Surface Treatment	Bright Chromate Plating	Fixing Pitch	51×40
Unit Price Qty. 1~9	14,72	Suppress Pressure(N)	1568
		Tare(g)	480
		Stroke(mm)	13

TC51BS

Old

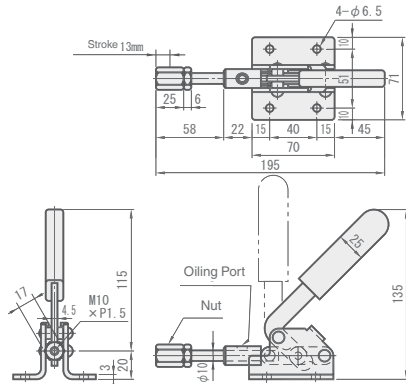

Part Number	TC51BXS	Open-Close Angle of Handle	42°
Body Material	1.0040/Ust.42.2	Mounting Bolt	M6
Surface Treatment	Bright Chromate Plating	Fixing Pitch	51×40
Unit Price Qty. 1~9	14,64	Suppress Pressure(N)	1600
		Tare(g)	450
		Stroke(mm)	13

TC51BXS

Old

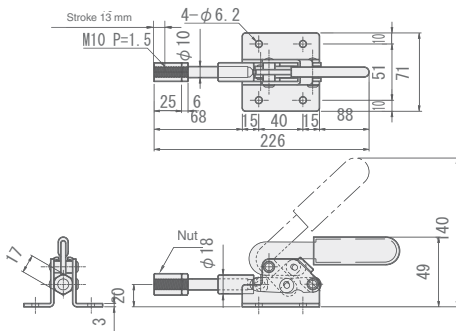

Part Number	MC07-4	Open-Close Angle of Handle	45°
Body Material	1.0040/Ust.42.2	Mounting Bolt	M6
Surface Treatment	Trivalent Chromate	Fixing Pitch	51×40
Unit Price Qty. 1~19	13,25	Suppress Pressure(N)	1568
		Tare(g)	460
		Stroke(mm)	12

MC07-4

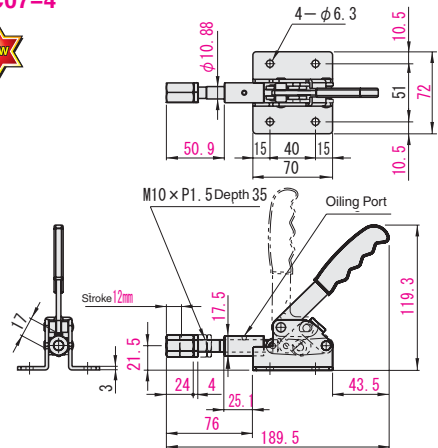

RoHS

Part Number	MC07-5	Open-Close Angle of Handle	45°
Body Material	1.0040/Ust.42.2	Mounting Bolt	M6
Surface Treatment	Trivalent Chromate	Fixing Pitch	51×40
Unit Price Qty. 1~19	13,18	Suppress Pressure(N)	1600
		Tare(g)	450
		Stroke(mm)	12

MC07-5

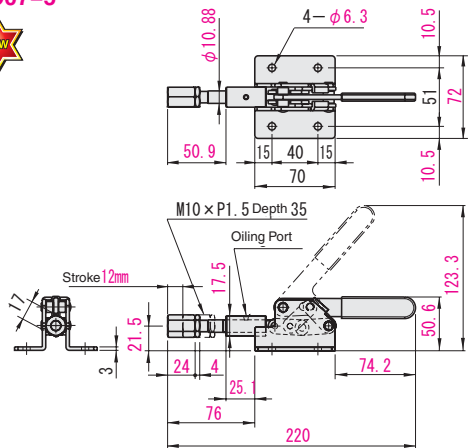

RoHS

Part Number	TC50A	Open-Close Angle of Handle	190°
Body Material	1.0040/Ust.42.2	Mounting Bolt	M6
Surface Treatment	Bright Chromate Plating	Fixing Pitch	45×32
Unit Price Qty. 1~9	14,32	Suppress Pressure(N)	1960
		Tare(g)	540
		Stroke(mm)	30

TC50A

Old

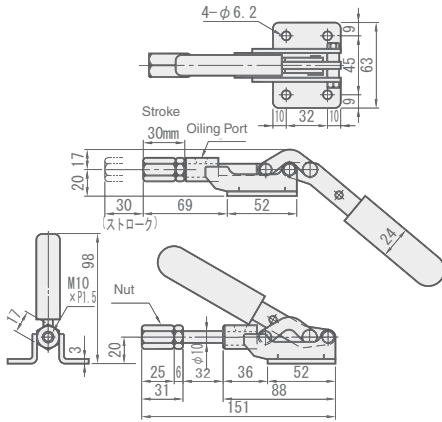

Part Number	TC02SM	Open-Close Angle of Handle	150°
Body Material	1.0040/Ust.42.2	Mounting Bolt	M6
Surface Treatment	Bright Chromate Plating	Fixing Pitch	34×40
Unit Price Qty. 1~9	29,80	Suppress Pressure(N)	1960
		Tare(g)	370
		Oilless Bushing	LFZB12-12 2Pcs.
		Stroke(mm)	30

TC02SM (Stroke Smooth Type)

Old

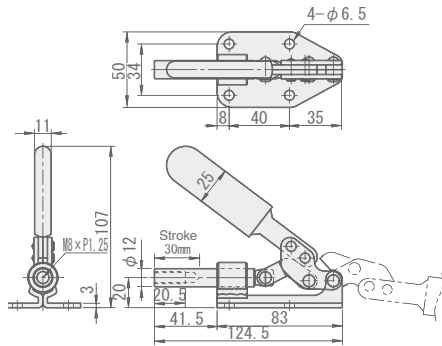

!The bushing has no oiling port.

Part Number	MC07-6	Open-Close Angle of Handle	190°
Body Material	1.0040/Ust.42.2	Mounting Bolt	M6
Surface Treatment	Trivalent Chromate	Fixing Pitch	45×32
Unit Price Qty. 1~19	12,89	Suppress Pressure(N)	1960
		Tare(g)	390
		Stroke(mm)	30

MC07-6

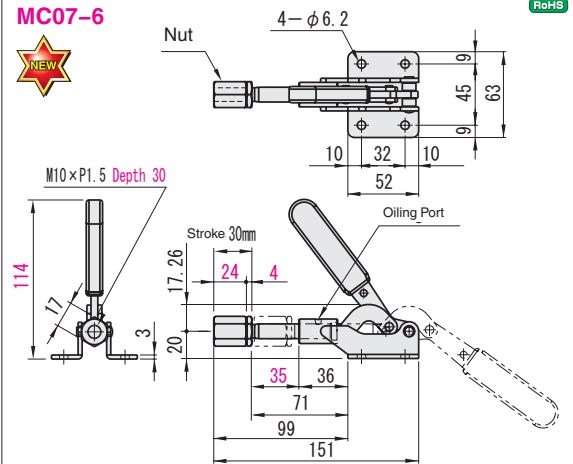

Part Number	MC08-1	Open-Close Angle of Handle	140°
Body Material	1.0040/Ust.42.2	Mounting Bolt	M6
Surface Treatment	Trivalent Chromate	Fixing Pitch	34×40
Unit Price Qty. 1~19	25,33	Suppress Pressure(N)	1960
		Tare(g)	380
		Oilless Bushing	LFZB12-20 1Pcs.
		Stroke(mm)	30

MC08-1 (Stroke Smooth Type)

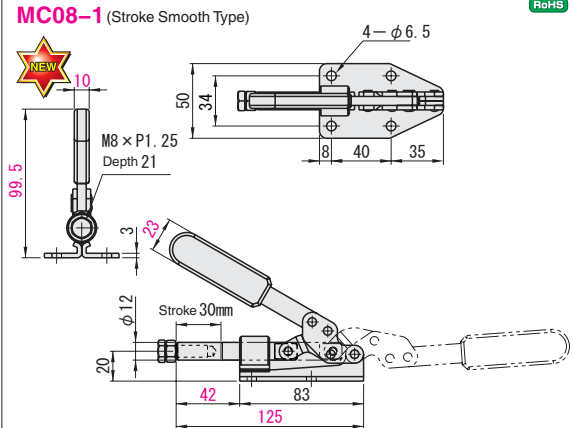

Welding Clamps

Part Number	VARI-1	VARI-2	VARI-3
Body Material	1.0040/Ust.42.2(With Hardened Bushing)		
Tare(g)	845	2130	4100
Suppress Pressure(N)	1960	4900	9800
Open-Close Angle of Handle	116°	120°	120°
Arm Movement Angle	187°	190°	190°
Unit Price Qty. 1~19	55,10	76,80	101,20

RoHS

VARI-1

Old

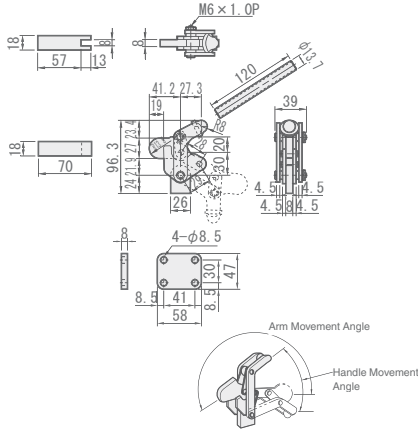

VARI-2

Old

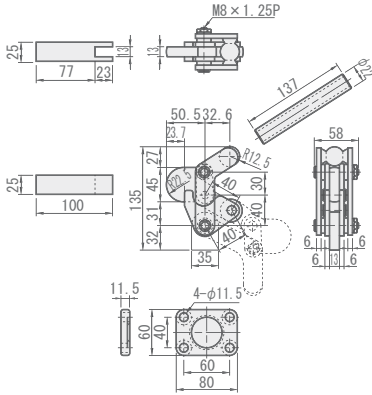

VARI-3

Old

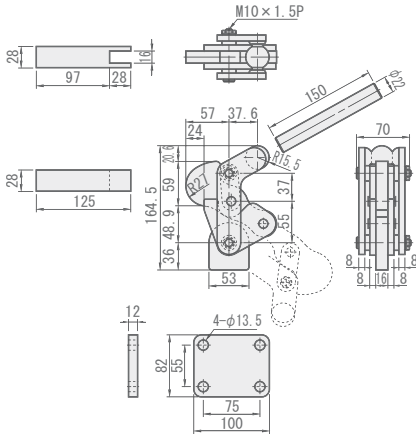

Metallic Heats for Clamps

Tip part		Bolt part		Type
M	H	M	S	
NBR	ShoreA70	Steel	Treated Chrome	TGB
		Stainless	-	STGB

Old

Diagram of a metallic heat with dimensions M, H, L, t1, t2, d1.

Part Number	M-t	L	t1	t2	d	d1	Unit Price Qty. 1-9	
Type	M-t	L	t1	t2	d	d1	TGB	STGB
4-13	23	8	8	12	2,10	4,40		
4-32	42	2			2,50	5,00		
6-37	51	12	10	16	3,30	5,80		
6-87	101				6,60	-		
8-49	67	5	13	12	4,00	7,00		
8-105	123				7,40	-		
10-59	85	6	20	16	24	7,20		
12-66	100	9	25	22	32	8,20		

Part Number	MC09-1	MC09-2	MC09-3
Body Material	1.0040/Ust.42.2(With Hardened Bushing)		
Tare(g)	845	2130	4100
Suppress Pressure(N)	1960	4900	9800
Open-Close Angle of Handle	122°	122°	128°
Arm Movement Angle	196°	191°	197°
Unit Price Qty. 1~19	49,59	69,12	91,08

RoHS

MC09-1

NEW

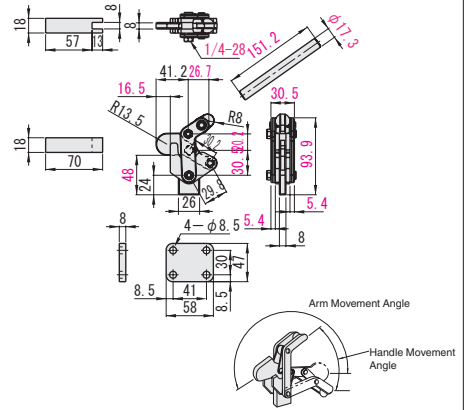

MC09-2

NEW

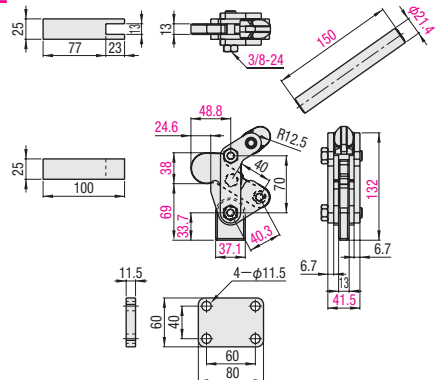

MC09-3

NEW

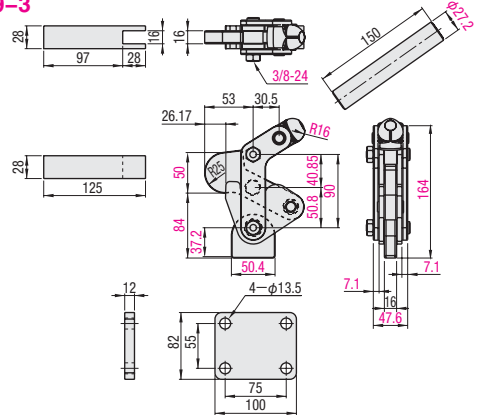

Type	Tip part	Bolt part	Part Number	M-t	L	t1	t2	d	d1	Standard Unit Price Qty. 1-9
	M	H	M	S	(Thread effective length)	(Length)				
MC□-□□	NBR	ShoreA70	Steel	Treated Chrome						
MC□-□□			Stainless	-						

Old part number TGB

NEW

Old part number STGB

Diagram of a metallic heat with dimensions M, H, L, t1, t2, d1.

Part Number	M-t	L	t1	t2	d	d1	Standard Unit Price Qty. 1-9
MC4-15	4-15	23			8	12	2,00
MC4-32	4-32	42	2		8	12	2,38
MC6-37	6-37	51			12	10	3,14
MC6-87	6-87	101			12	10	6,27
MC8-45	8-45	63			5	13	3,80
MC8-105	8-105	123			5	13	7,03
MC10-59	10-59	85	6	20	16	24	6,84
MC12-66	12-66	100	9	25	22	32	7,79

Part Number	M-t	L	t1	t2	d	d1	Standard Unit Price Qty. 1-9
MCS4-15	4-15	23			8	12	3,96
MCS4-32	4-32	42	2		8	12	4,50
MCS6-37	6-37	51			12	10	5,22
MCS8-45	8-45	63			5	13	6,30

Part Number	MC04-1LS	Open-Close Angle of Arm	100°
		Open-Close Angle of Handle	56°
Body Material	1.0040/Ust.42.2	Mounting Bolt	M4
Surface Treatment	Trivalent Chromate	Fixing Pitch	15.9
Accessory	Bolt with Rubber (A70)	Suppress Pressure(N)	186
Unit Price Qty. 1~19	11,70	Tare(g)	75

MC04-1LS

RoHS

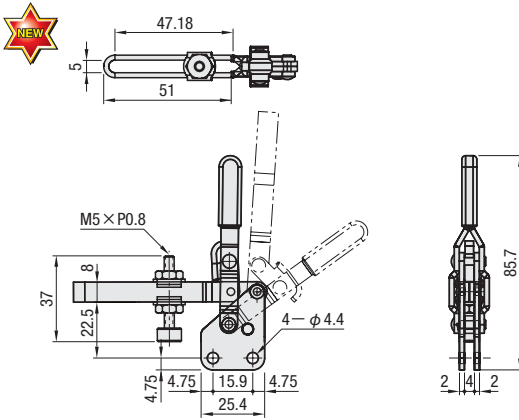

Part Number	MC04-2LS	Open-Close Angle of Arm	95°
		Open-Close Angle of Handle	60°
Body Material	1.0040/Ust.42.2	Mounting Bolt	M5
Surface Treatment	Trivalent Chromate	Fixing Pitch	12.7
Accessory	Bolt with Rubber (A70)	Suppress Pressure(N)	392
Unit Price Qty. 1~19	11,09	Tare(g)	175

MC04-2LS

RoHS

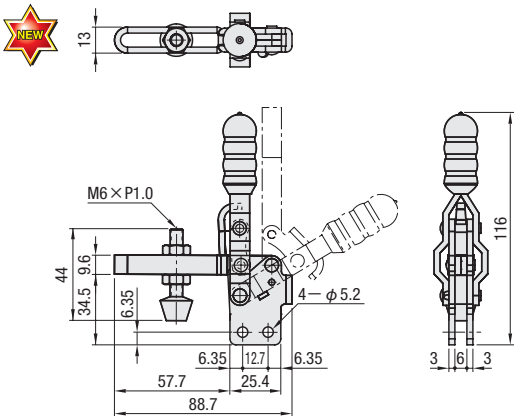

Part Number	MC04-3LS	Open-Close Angle of Arm	100°
		Open-Close Angle of Handle	56°
Body Material	1.0040/Ust.42.2	Mounting Bolt	M6
Surface Treatment	Trivalent Chromate	Fixing Pitch	19
Accessory	Bolt with Rubber (A70)	Suppress Pressure(N)	784
Unit Price Qty. 1~19	16,88	Tare(g)	370

MC04-3LS

RoHS

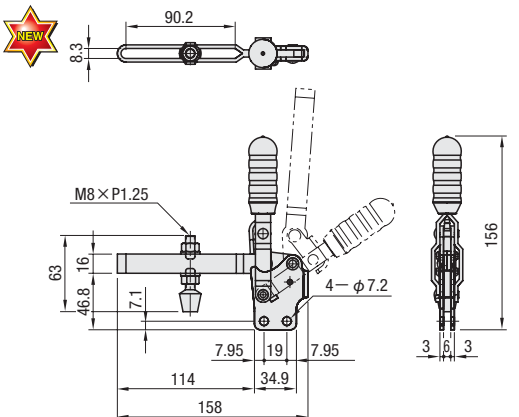

Part Number	MC04-4LS	Open-Close Angle of Arm	106°
		Open-Close Angle of Handle	58°
Body Material	1.0040/Ust.42.2	Mounting Bolt	M8
Surface Treatment	Trivalent Chromate	Fixing Pitch	31.8
Accessory	Bolt with Rubber (A70)	Suppress Pressure(N)	1078
Unit Price Qty. 1~19	22,47	Tare(g)	815

MC04-4LS

RoHS

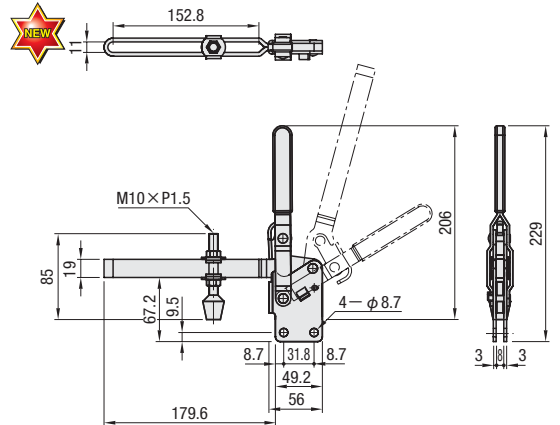

Part Number	MC04-5	Open-Close Angle of Arm	100°
		Open-Close Angle of Handle	56°
Body Material	1.0040/Ust.42.2	Mounting Bolt	M6
Surface Treatment	Trivalent Chromate	Fixing Pitch	31.8x19
Accessory	Bolt with Rubber (A70)	Suppress Pressure(N)	2270
Unit Price Qty. 1~19	12,00	Tare(g)	340

MC04-5

RoHS

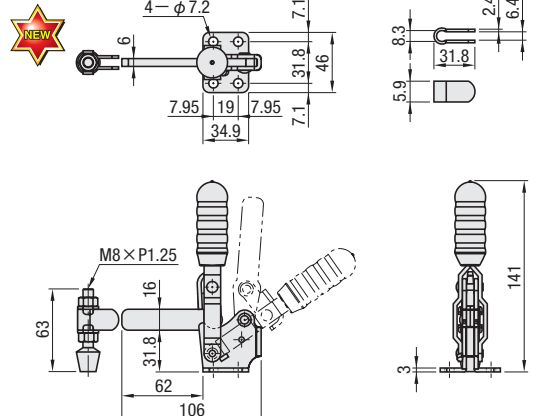

MISUMI Europa GmbH

Katharina-Paulus-Str.6
DE-65824 Schwalbach/Ts.
Tel: +49 (0) 6196 7746 0
Fax: +49 (0) 6196 7746 364
URL: <http://www.misumi-europe.com>
eMail: insales@misumi.de

MISUMI UK LTD.

No.1, The Courtyard, 76-78 High Street
Staines, Middlesex TW18 4DP, UK
Tel: +44 (0) 1784 465530
Fax: +44 (0) 1784 466695
URL: <http://www.misumi-europe.com>
eMail: insales@misumi-europe.com

