

ECO 30 E



short description

Oscillating industrial fans for ceiling and wall installation

Article number 0088.0010

Technical Data

Air circulation	2,800 m ³ /h
Rotating speed	1,350 1/min
Impeller diameter	300 mm
Speed controllable	✓
Reversing capacity	—
Type of voltage	Alternating current
Rated voltage	230 V
Frequency	50 Hz
Power consumption	37 W
I _{max}	0.25 A
Degree of protection (IP)	20
Installation site	Wall, Ceiling
Installation position	vertical, horizontal
Weight	3.7 kg
Swivellable	✓
Airstream temperature at nominal current	40 °C
Airstream temperature at I _{Max}	40 °C
Ambient temperature:	40 °C
Range	C
EAN	4012799880103
Total L _{WA1} , high (total sound power level for the greenhouse fans, free inlet and free o)	57 dB(A)

ECO 30 E

Dimensions [mm]

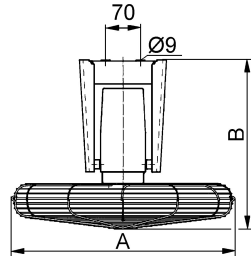

A	B
345	330