

PCB connector for SMD

140-A-126-SMD

Screw connection, with solder flanges

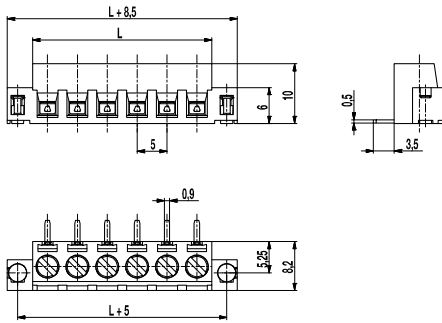

PCB Layout

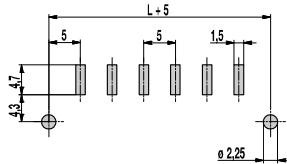

Solder paste thickness: 0,15 - 0,2 mm

The 2 to 12 pole terminals with a pitch of 5 mm have a screw connection with elevator clamping system and are equipped with M3 captive screws. The wire clamp and soldering tag are manufactured as a single unit and permanently engaged in the casing. The solder pins are exactly aligned parallel to the printed circuit board in order to create a coplanar connection after the reflow soldering process.

Soldering cylinders on either side of the housing (floating anchors), are movable in vertical direction and thereby they obtain 100% coplanarity between solder pins and soldering cylinders. They are transferred more to the front in comparison to the connector centre in order to keep the retaining strength, where the wires are connected. Thus, the force, acting on the solder pins, is reduced in a very important way.

At the base side the housing is equipped with spacers (stand offs), which ensure a better air circulation during the Reflow soldering process and thus an optimal soldering result.

Packed in magazines or equipped with Pick Discs in Tape-on-Reel, this genuine SMD terminal is suitable for the automatic assembly.

Part Numbers

No. of poles	140-A-126-SMD	Length	Pcs
2	10.801.632	10,00	784
4	10.801.634	20,00	504
6	10.801.636	30,00	364
8	10.801.638	40,00	280
10	10.801.640	50,00	224
12	10.801.642	60,00	196

further number of poles on request

General Information

Pitch	5 mm
No. of poles	2 - 12
Areas of application	Systems for measurement and control

Technical Data

Clamping Range	<i>solid / flexible / AWG</i> 0,14 - 2,5 mm ² / 0,14 - 1,5 mm ² / 26 - 16 AWG		
Rated Cross Section	1,5 mm ²		
Wire Stripping Length	6 mm ± 0,5 mm		
Overvoltage Category	III	III	II
Pollution Severity Level	3	2	2
Rated Voltage	200 V	320 V	500 V
Rated Impulse Voltage	4 kV	4 kV	4 kV
Rated Insulation Voltage	250 V acc. to EN 60998-1		
Rated Current	15 A		
Soldering process	Reflow solder		
Torque	0,5 Nm		

Material

Moulding	PA HT, black, V-0
Comparative Tracking Index	CTI ≥ 600
Insulating Group	I
Temperature Range	-40°C up to 150°C; reflow solder temperature (Peak) max. 260°C (15-30 s)
Terminal body	Nickel plated brass
Pressure clamp	Tin plated tin bronze
Screw	M3; zinc plated steel, blue passivated
Solder pin	0,9 x 0,5 mm; tin plated tin bronze
Solder cylinder	Tin plated brass

Approvals

	Current	Voltage	Group	AWG	Nm
	10 [1]	300	B, D	30 - 14	0,51
	15	300	B	30 - 14	0,51

Options / Accessories

- Consecutive numbering
- Special marking according to drawing
- Self-adhesive marking strip BST-5,00 [2]

Part Numbers: Tape-on-Reel

No. of poles	140-A-126-SMD	Tape Width	Tape Height	Pcs
2	10.801.632.A00	32 mm	13 mm	375
3	10.801.633.A00	56 mm	13 mm	375
4	10.801.634.A00	56 mm	13 mm	375
5	10.801.635.A00	56 mm	13 mm	375
6	10.801.636.A00	56 mm	13 mm	375

further number of poles on request

[1] 20 A max for factory-wiring applications only
 [2] To be fitted after reflow soldering process