

**R** RENOWNED  
KNOW-HOW



**RK ROSE+KRIEGER**

A Phoenix Mecano Company

Selection guide

# *Connecting Technology*

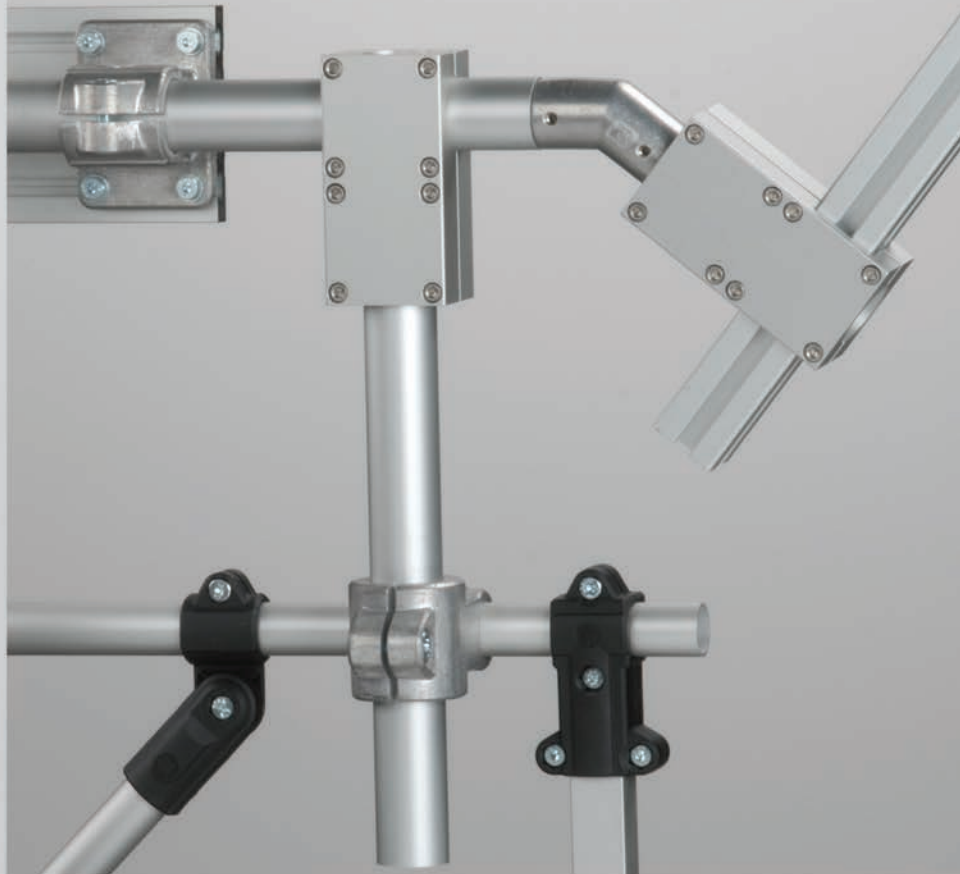

# Flexible Clamping

Connecting precision round and square tube reliable and stable whilst also making releasing easy appears to be a difficult task. The RK connecting technology, which has been proven over years of use, meets this requirement in a simple and almost perfect fashion.

Our versatile connection elements offer you the chance to implement creative and flexible solutions, because you can rely on our product. We are sure to have the right part for you, and if not we will develop one especially for you.

## Why drilling, riveting, welding...



...when it's quicker with our reliable clamping system.

## The four steps to your product recommendation

### Step 1: The application always takes centre stage



- Light load range
- Medium to heavy load range
- Shock-proof load range

### Step 2: What features should the product have?



- Right angle tube connection
- Axially parallel tube connection
- Hinge tube connection

### Step 3: Which product design do you want?



- Single-piece elements: For faster and more economic assembly
- Multi-piece elements: For later on assembly and upgrading

### Step 4: Which performance category do you require?

- Round tube
- Square tube
- Ø Diameter
- □ Square

...follow our system and the terms are self explanatory.

# The RK Connecting Circle

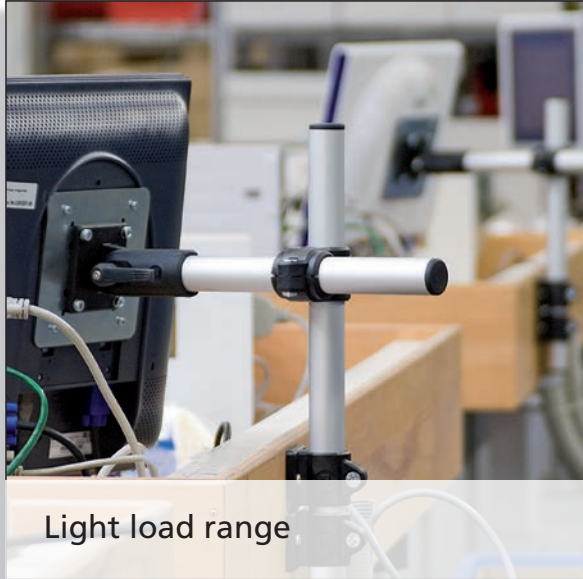

## Features:

- ✓ Easy
- ✓ Good value
- ✓ Variable



**Light Clamps**  
continue on page 6

Your appli  
takes centr

## Solid Clamps

continue on page 8



Medium to heavy load range

### Features:

- ✓ Reliable
- ✓ Solid
- ✓ Price/Performance optimised
- ✓ Great variety



ation  
e stage

## Robust Clamps

continue on page 10



Shock-proof load range

### Features:

- ✓ Extremely strong
- ✓ Vibration proof
- ✓ Impact and shock load
- ✓ Corrosion resistant



# Light Clamps

Light load range



## Plastic:

- ✓ Corrosion resistant
- ✓ Low weight
- ✓ Usable in food packaging
- ✓ Variable using reducing bushes

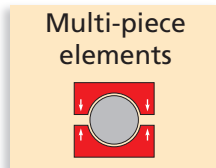
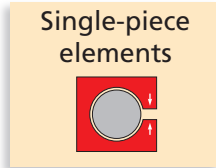

### Right angle tube connector

Cross clamps	Angle clamps	Base clamps
<p>Ø 12 - 30 □ 10, 20</p>	<p>Ø 12 - 30 □ 10, 20</p>	<p>Ø 12 - 30 □ 10, 20</p>
<p>Ø 20 - 30 □ 20 - 30</p>	<p>Ø 20 - 30 □ 20 - 30</p>	<p>Ø 20 - 30 □ 20 - 30</p>

Ø = Diameter round tube  
□ = Dimension square tube

## Light Clamps

Plastic

### Connecting types

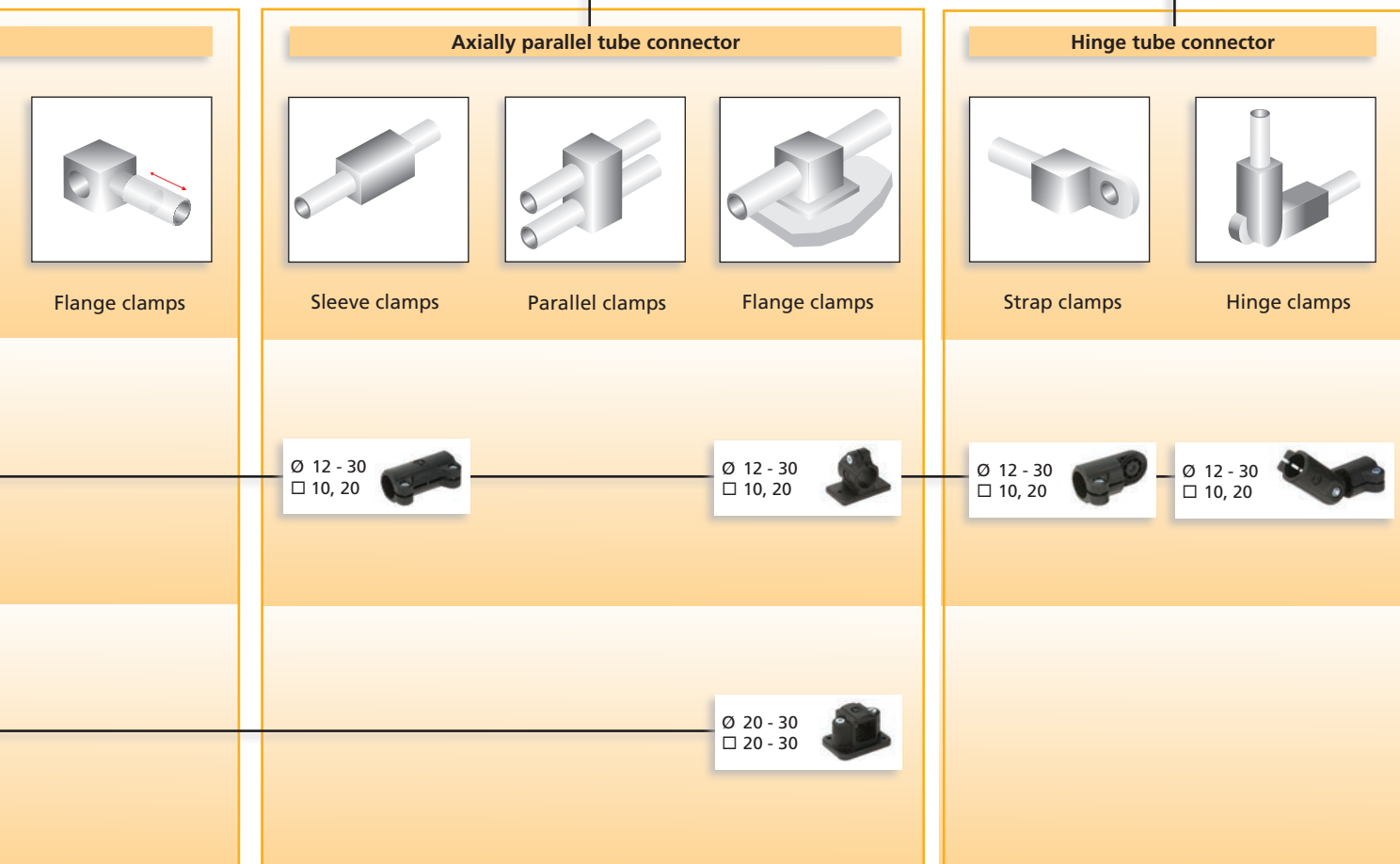

For detailed information, sizing and accessories, please look in our main catalogue Connecting Technology



# Solid Clamps Medium to heavy load range



## Industrial-Design

- ✓ Cast aluminium
- ✓ Great variety
- ✓ Single-piece elements

## quad® elements

- ✓ Extruded aluminium
- ✓ Maximum torque loads
- ✓ High-quality anodized surface
- ✓ Single- und Multi-piece elements

## Block form

- ✓ Cast aluminium
- ✓ Higher torque loads
- ✓ Plane surface
- ✓ Multi-piece elements

Single-piece elements

Industrial-Design

quad® elements

Multi-piece elements

quad® elements

Block form

### Right angle tube connector

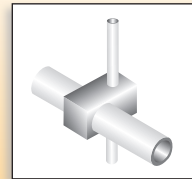

Cross clamps

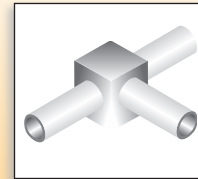

Angle clamps

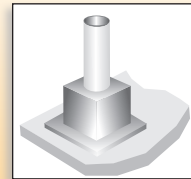

Base clamps

Ø 12-80



Ø 12-80



Ø 12-80



Ø 30-50



Ø 30-50



Ø 30-60



Ø 30-60

□ 30-60



Ø 30-60

□ 30-60



Ø 30-80

□ 30-60



Ø 8-80

□ 10-80



Ø 8-80

□ 10-80



Ø 8-80

□ 10-80



Ø = Diameter round tube  
□ = Dimension square tube



## Solid Clamps

Aluminium

### Connecting types

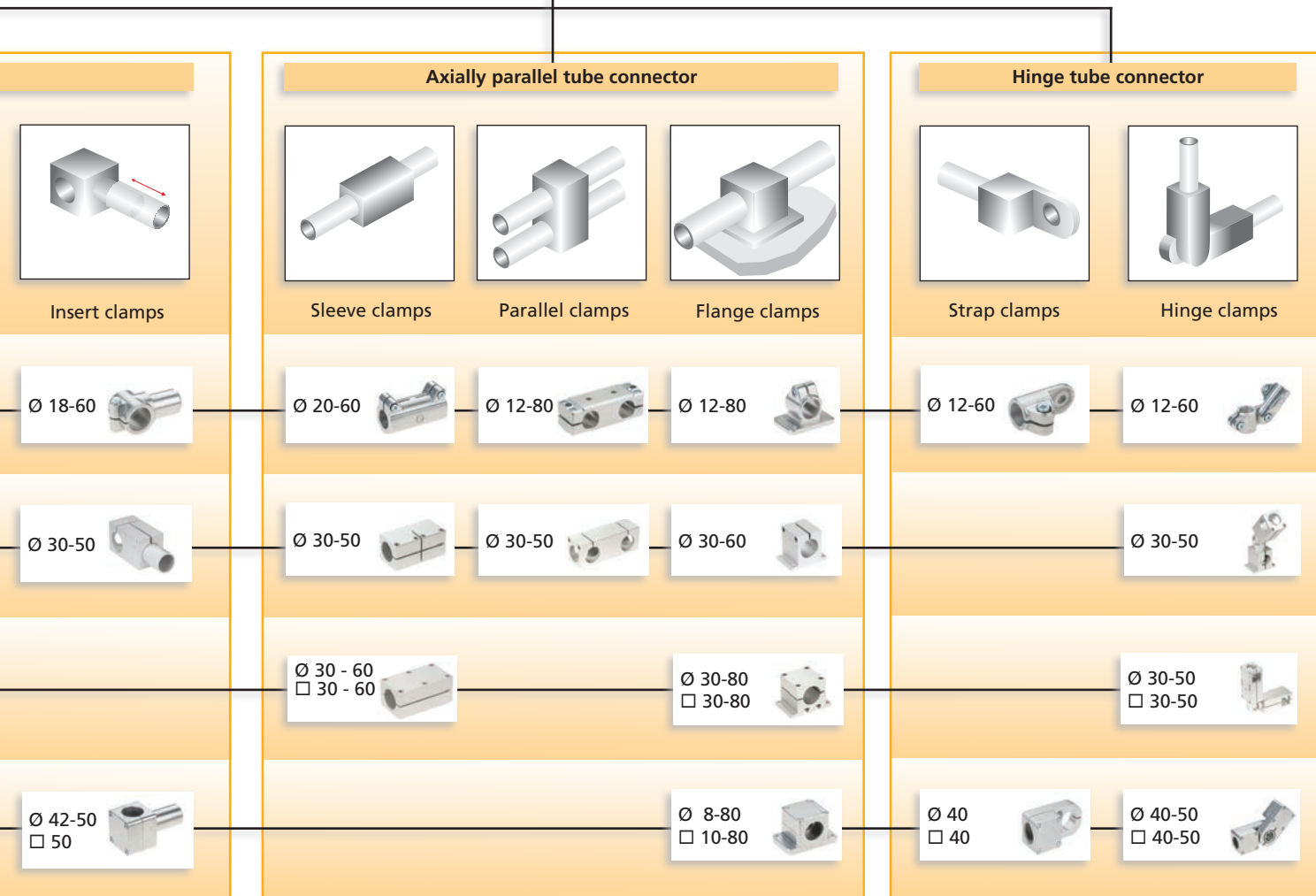

For detailed information, sizing and accessories, please see our main catalogue „Connecting Technology“.

# Robust Clamps Shock-proof load range



## Stainless steel

- ✓ Extremely strong for dynamic loads
- ✓ High temperature resistant
- ✓ Corrosion resistant

## Robust Clamps

Stainless steel

### Connecting types

#### Right angle tube connector

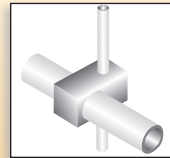

Cross clamps

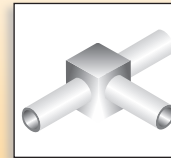

Angle clamps

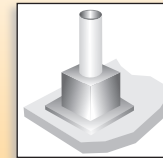

Base clamps

#### Axially parallel tube connector

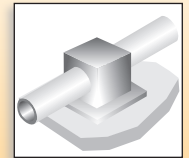

Insert clamps

#### Single-piece elements



#### Multi-piece elements



Ø = Diameter round tube  
□ = Dimension square tube

# Accessories



Steel tubes  
Ø = 12-80  
□ = 20-80



Stainless steel tubes  
Ø = 12-60  
□ = 20-80



Aluminium tubes  
Ø = 20-60  
□ = 20-60



Aluminium bars  
Ø = 8-10  
□ = 10



Round tube stopper



Adjustable foot



Steerable castor with tube fitting



Square tube stopper



Adjustable foot with tube fitting



Fixed castor with tube fitting



Round tube threaded stopper



Square tube threaded stopper



Adjustable levers

## No drilling or welding, no bevel cut

ITAS designs make it easy to assemble simple railings as well as sophisticated stairs and working platforms. The ITAS „Internal Tension Application System“ is an easy plug in principle. It reduces assembly time to a minimum. The connection is realized by tightening special clamping screws. The smooth intersections persuade with a pleasant surface feeling and contribute to the overall safety.

– just assemble –

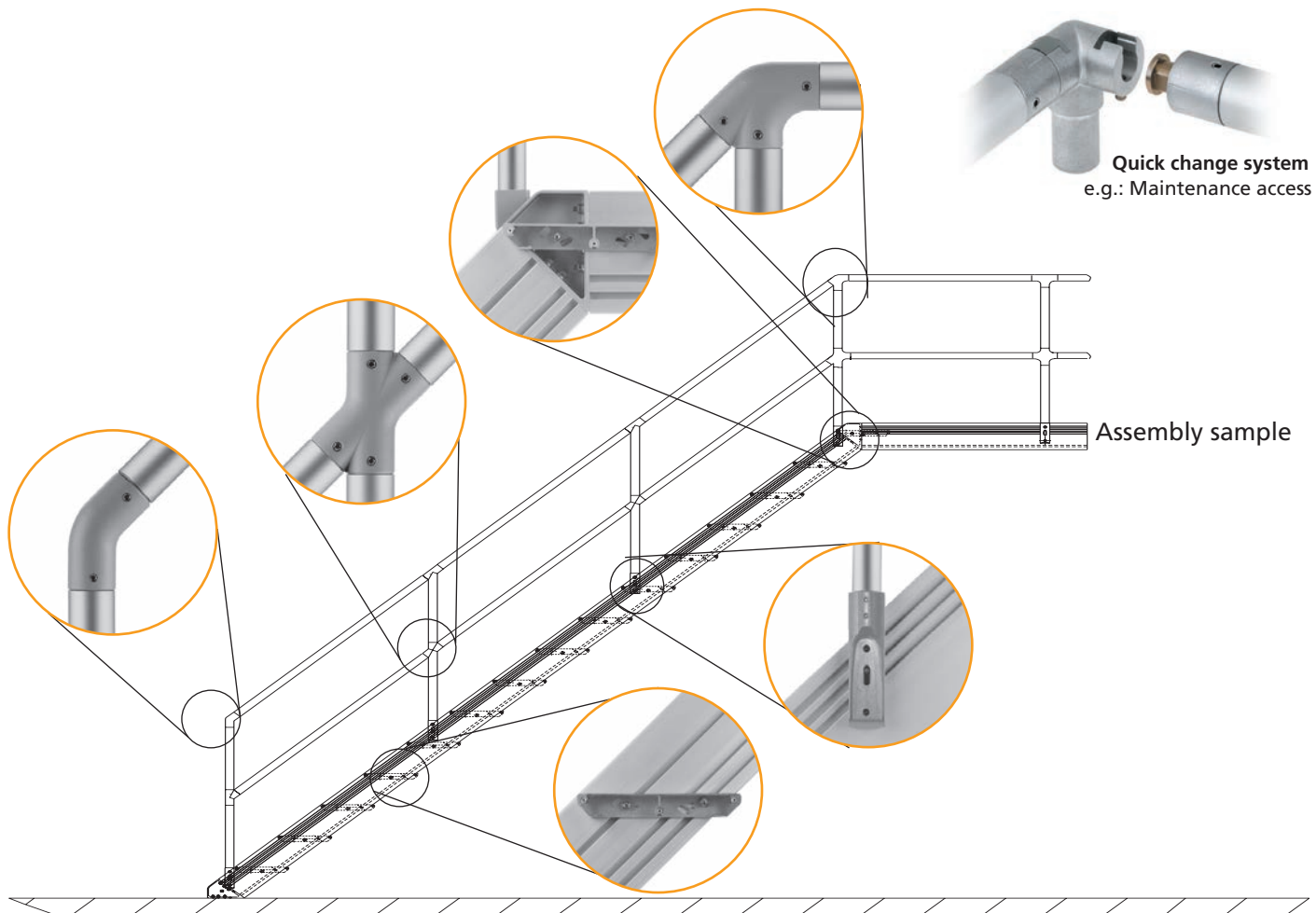

## Application samples



For detailed information, sizing and accessories, please see our main catalogue „Connecting Technology“.



# Application



Work trolley



Adjustable support for an Inkjet-Coder



Deposit rack in front of an annealing furnace

For detailed information, sizing and accessories, please see our main catalogue „Connecting Technology“.



## Our service

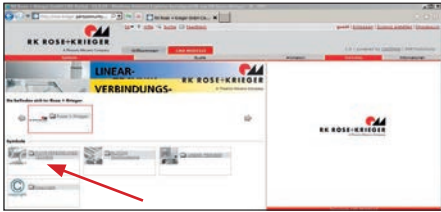

### What we can do for you:

#### CAD-component library (Part server)

To support your design work we offer component data free of charge in the Rose+Krieger-component library (drawings, technical descriptions). About 60 different file formats (2D/3D) can be selected here.



#### RK-Infomobile – the exhibition at your location

Over 20 presentation boards with exhibits and functional examples, as well as many applications of drive and linear technology to give you a complete overview of RK products.



#### RK-Field service - Advice on site

Our Key Account managers and sales consultants are happy to visit you on site and help you draw up concrete proposals for practical solutions.

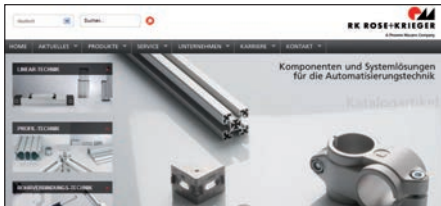

#### RK-website

On our website you will find lots of information about our company and our products . You will also find your contact partner in your area and the latest catalogue data (in PDF format) to download.

[www.rk-rose-krieger.com](http://www.rk-rose-krieger.com)

Do you need to focus your resources on other tasks and are you looking for a competent partner you can rely on? Working in close collaboration with you, our specialists will develop solutions tailor-made to meet your needs. If you wish, we can also assemble and commission the units on site.

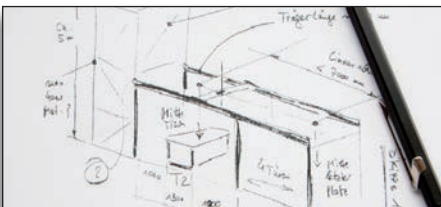

Just make a sketch of your requirements



Our product specialists will devise a solution for you



We can deliver your turnkey solution or assemble and commission it for you on site



**R** RENOWNED  
KNOW-HOW

**LINEAR-  
PROFILE-  
CONNECTING-  
MODULE-**

**TECHNOLOGY**



**RK ROSE+KRIEGER**

A Phoenix Mecano Company

Postfach 15 64  
D-32375 Minden  
Tel.: +49 5 71 93 35-0  
Fax: +49 5 71 93 35-119  
info@rk-online.de  
www.rk-rose-krieger.com